

PROPOSED HARTLEY BRIDGE SHOWING PROPOSED NAVIGATION CLEARANCE (IN YELLOW)
Scale: 1/100

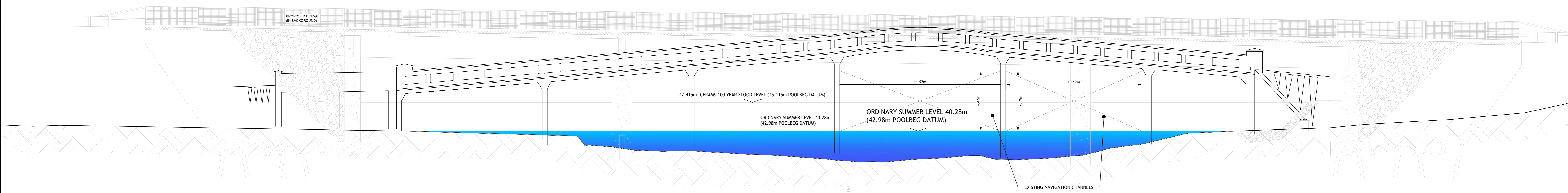

EXISTING HARTLEY BRIDGE SHOWING EXISTING NAVIGATION CLEARANCE (IN ORANGE)
Scale: 1/100

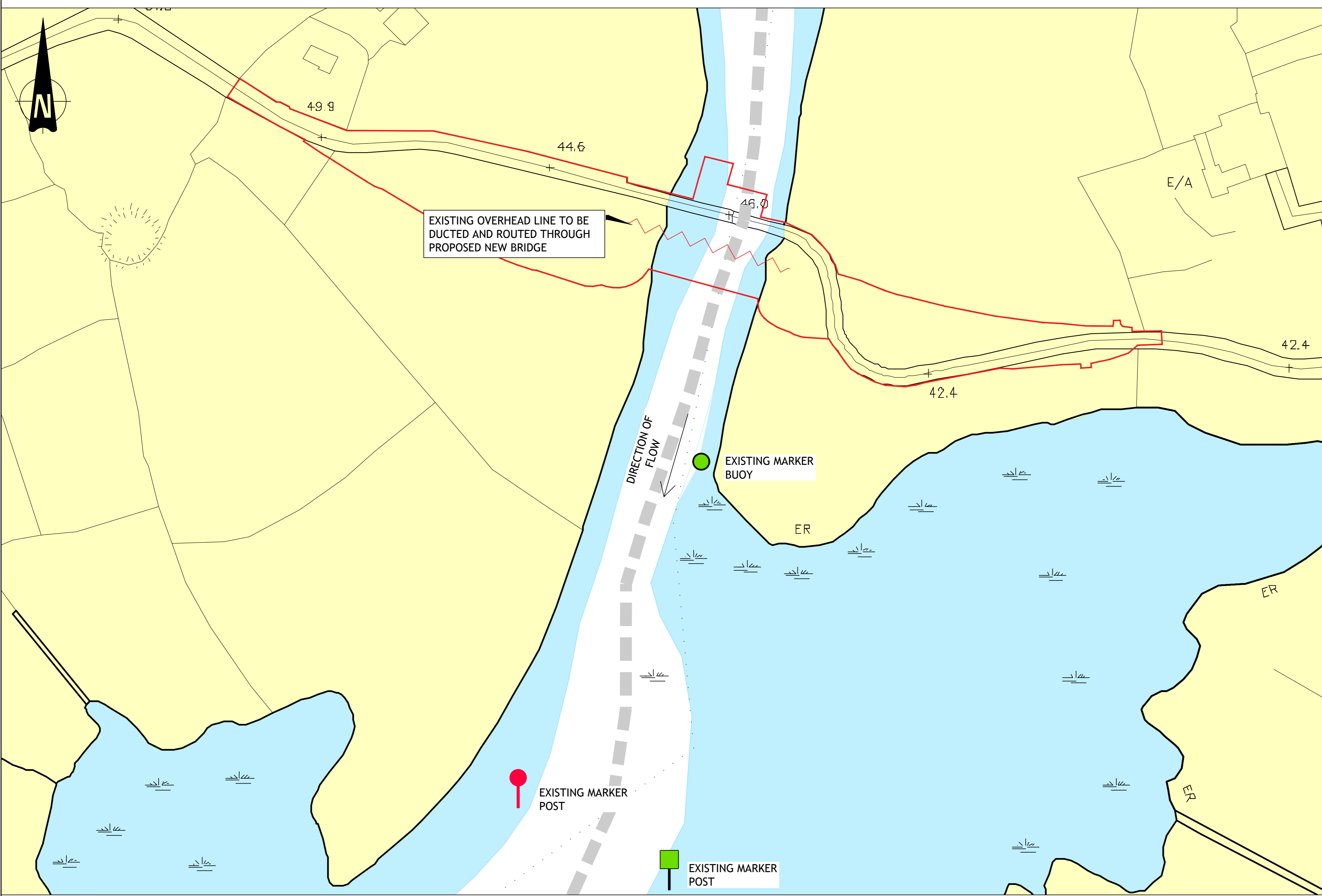

EXISTING HARTLEY BRIDGE NAVIGATION MARKS
SCALE 1:1000

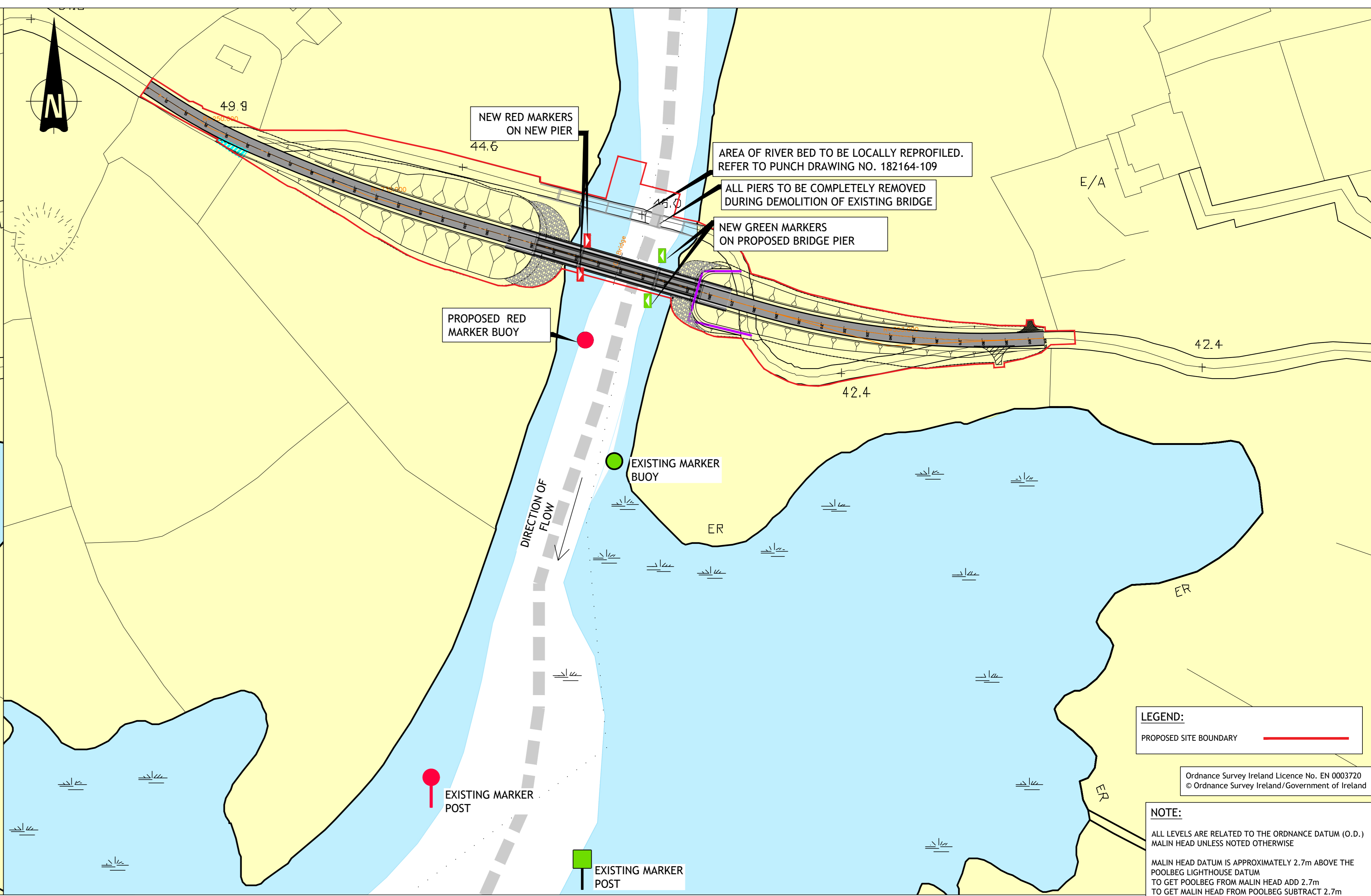

PROPOSED HARTLEY BRIDGE NAVIGATION MARKS
SCALE 1:1000

LEGEND:
PROPOSED SITE BOUNDARY

NOTE:
ALL LEVELS ARE RELATED TO THE ORDNANCE DATUM (O.D.) MALIN HEAD UNLESS NOTED OTHERWISE.
MALIN HEAD DATUM IS APPROXIMATELY 2.7m ABOVE THE POOLBEG LIGHTHOUSE DATUM.
TO GET POOLBEG FROM MALIN HEAD ADD 2.7m
TO GET MALIN HEAD FROM POOLBEG SUBTRACT 2.7m (SOURCE OS)
ALL WATER LEVELS TO BE CONFIRMED WITH WATERWAYS IRELAND

Ordnance Survey Ireland Licence No. EN 0003720
© Ordnance Survey Ireland/Government of Ireland

© PUNCH Consulting Engineers
This drawing and any design herein is the copyright of the Consultants and must not be reproduced without their written consent.
All drawings remain the property of the Consultants.
Figured dimension only to be taken from this drawing.
Consultants to be informed immediately of any discrepancies before work proceeds.

Date Drawn: September 2020	Drawn By: S Buckley	Date Issued:	Issued By:
----------------------------	---------------------	--------------	------------



Rev	Amendment	By	Date	Rev	Amendment	By	Date
PLD	ISSUED FOR PLANNING	HBS	2021/09/10				



Client: **Comhairle Chontae Leitrim**
Leitrim County Council

Job: **HARTLEY BRIDGE REPLACEMENT**
Title: **BRIDGE NAVIGATION DETAILS**

PUNCH consulting engineers
Dublin | Limerick | Cork | Galway | Glasgow
Carnegie House, Library Road, Dun Laoghaire, Co. Dublin, A96 C747
IRL: +353 1 271 2200 www.punchconsulting.com

Scale: # As Shown
Technician Check: S Buckley
Engineer Check: J Roche
Approved: [Signature]
Date: [Date]

182-164-108 PLO