

LEGEND:

FORWARD MOVEMENT 
 REVERSING MOVEMENT 

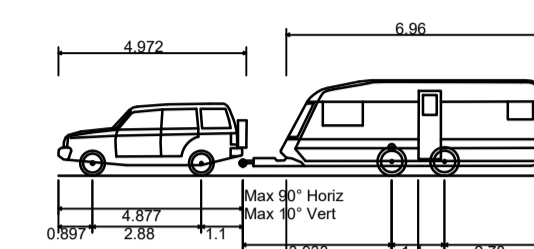

Luxury 4x4 +Twin Axle Caravan (2006)
 Overall Length 12.990m
 Overall Width 2.286m
 Overall Body Height 2.524m
 Min Body Ground Clearance 0.251m
 Max Track Width 2.130m
 Lock-to-lock time 4.00s
 Curb to Curb Turning Radius 5.800m

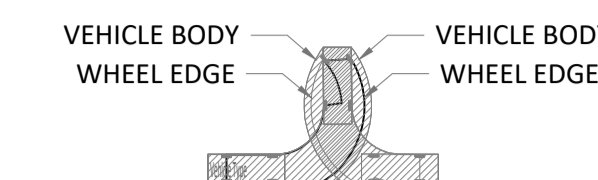
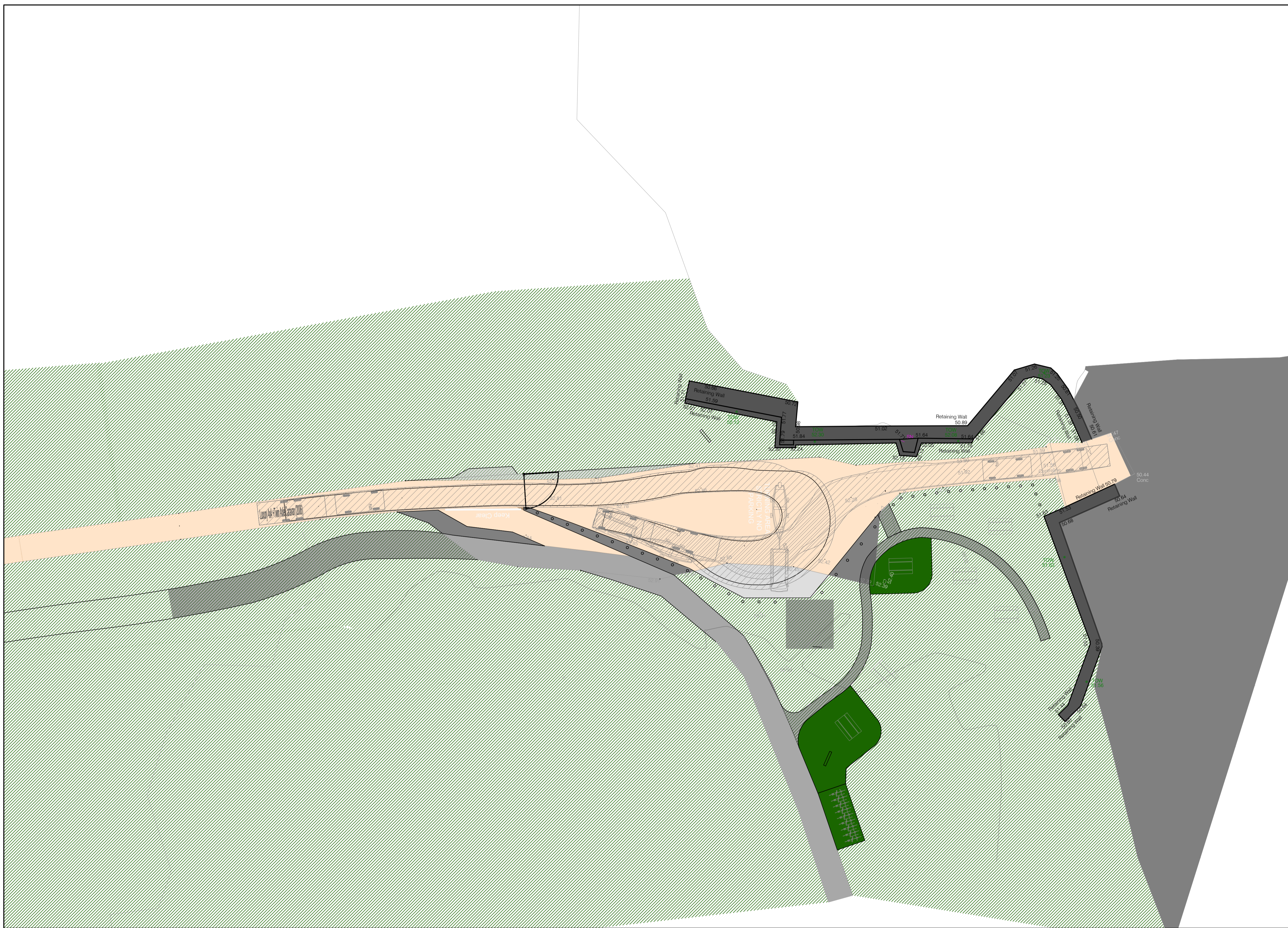

- THIS DRAWING TO BE READ IN CONJUNCTION WITH ALL OTHER RELEVANT DESIGN TEAM DRAWINGS AND SPECIFICATIONS.
- FOR SETTING OUT REFER TO ARCHITECT'S DRAWINGS. DO NOT SCALE THIS DRAWING. USE FIGURED DIMENSIONS ONLY.
- NO PART OF THIS DOCUMENT MAY BE REPRODUCED OR TRANSMITTED IN ANY FORM OR STORED IN ANY RETRIEVAL SYSTEM OF ANY NATURE WITHOUT THE WRITTEN PERMISSION OF O'CONNOR SUTTON CRONIN AS COPYRIGHT HOLDER EXCEPT AS AGREED FOR USE ON THE PROJECT FOR WHICH THE DOCUMENT WAS ORIGINALLY ISSUED.

Rev No.	Date	Revision Note	Drn by	Chkd by
P01	21/11/23	ISSUED FOR PLANNING	CW	AN

Rev No.	Date	Revision Note	Drn by	Chkd by



OCSC
 O'CONNOR SUTTON CRONIN
 MULTIDISCIPLINARY CONSULTING ENGINEERS
 Civil / Structural / Environmental / Mechanical / Electrical / Sustainability
 Cork Office: North Point House, North Point Business Park, New Mallow Road, Cork.
 Tel: +353 (0)21 2355816 Web: www.ocsc.ie
 Dublin London Belfast Galway Cork Birmingham

Client: COILLTE CGA
 Project: GLENFARNE WOODS, CO. LEITRIM
 Title: AUTOTRACK REPLACEMENT FOR CAR AND BOAT TRAILER

Code	Originator	Zone	Level	Type	Role	Number	Status	Revision
C1059	OCSC	XX	DR	C		0062	S8	P01

Date: 11/23 Scale @ A1: 1/200 Drn by: CW Chkd by: AN Aprvd by: JMcB