

**KEY:**  
 — PROPOSED GROUND LEVEL  
 — EXISTING GROUND LEVEL

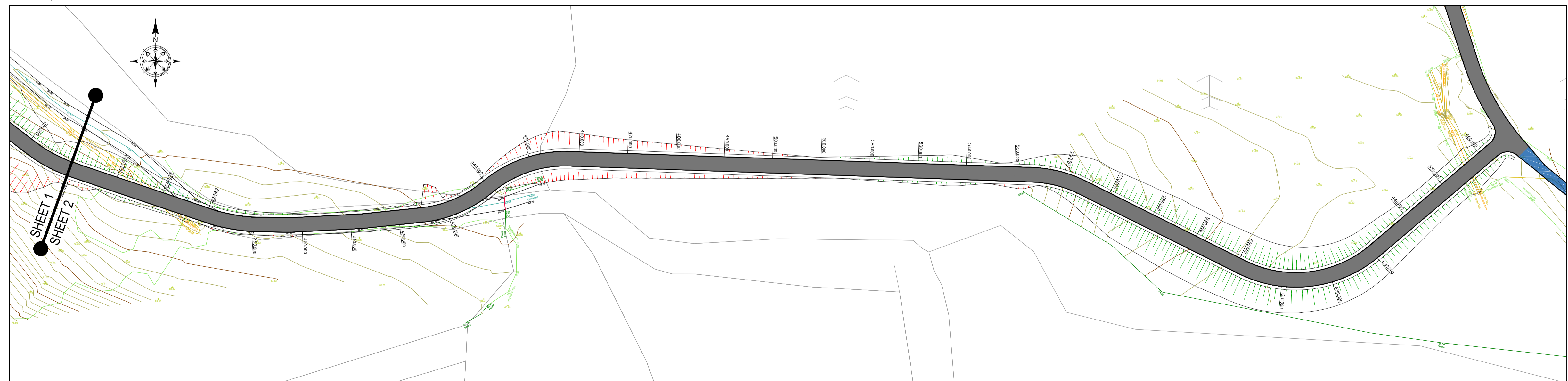

P1 ISSUED FOR PLANNING		KL 01.12.23
REV.	AMENDMENT	BY DATE
DRAWN:	KL	TECH. CHECK: KF
SCALE @ A1:	1:500	ENG. CHECK: FF
DATE:	22.08.2023	APPROVED: SS
STAGE:	Planning	
JOB TITLE:	Walking & Cycle Trails, Glenarne Wood County Leitrim	
DRAWING TITLE:	Proposed Trail Long Section Sheet 2 of 3	
CLIENT:	Coillte / Leitrim County Council	
DRAWING No:	123124-153	REV: P1

**CST Group**  
 Chartered Consulting Engineers  
 1, O'CONNELL ST.  
 SUGO  
 F91 W7YV  
 IRELAND  
 +353 71 919 4500  
 info@cstgroup.ie  
 www.cstgroup.ie