

Drumshanbo Town Centre Regeneration Project

Landscape Design Strategy

Issue 5

December 2023



CONTENTS

1.0 Introduction	3
2.0 Site Analysis	4
2.1 Site location	5
2.2 Permeability & Connectivity	6
2.3 Existing Open Space Functions	8
2.4 Topography	9
2.5 Existing Vegetation	10
2.6 Existing Boundary Treatments	11
2.7 Visual Connections - Intervisibility	13
3.0 Concept Vision	14
3.1 Design Rationale	15
3.1.1 Landscape Strategy - Improving Permeability & Connectivity	16
3.1.2 Landscape Strategy - Improving Space Functionality	18
3.1.3 Landscape Strategy - Existing Vegetation & Proposed Planting	19
3.1.3 Landscape Strategy - Improving Visual Connections - Intervisibility	20
3.1.4 Landscape Strategy - Nature Based Design	22
3.1.5 Landscape Strategy - Overall Plan	23
4.0 Landscape Proposals	24
4.1.1 Overall Landscape Plan	25
4.1.2 Detail Area 1 & Sections	26
4.1.3 Detail Areas 2 & 3	26
4.1.4 Play Area	28
4.1.5 Hardworks Details	29
4.1.6 Lighting Proposals	30
4.1.7 Planting Schedule	31

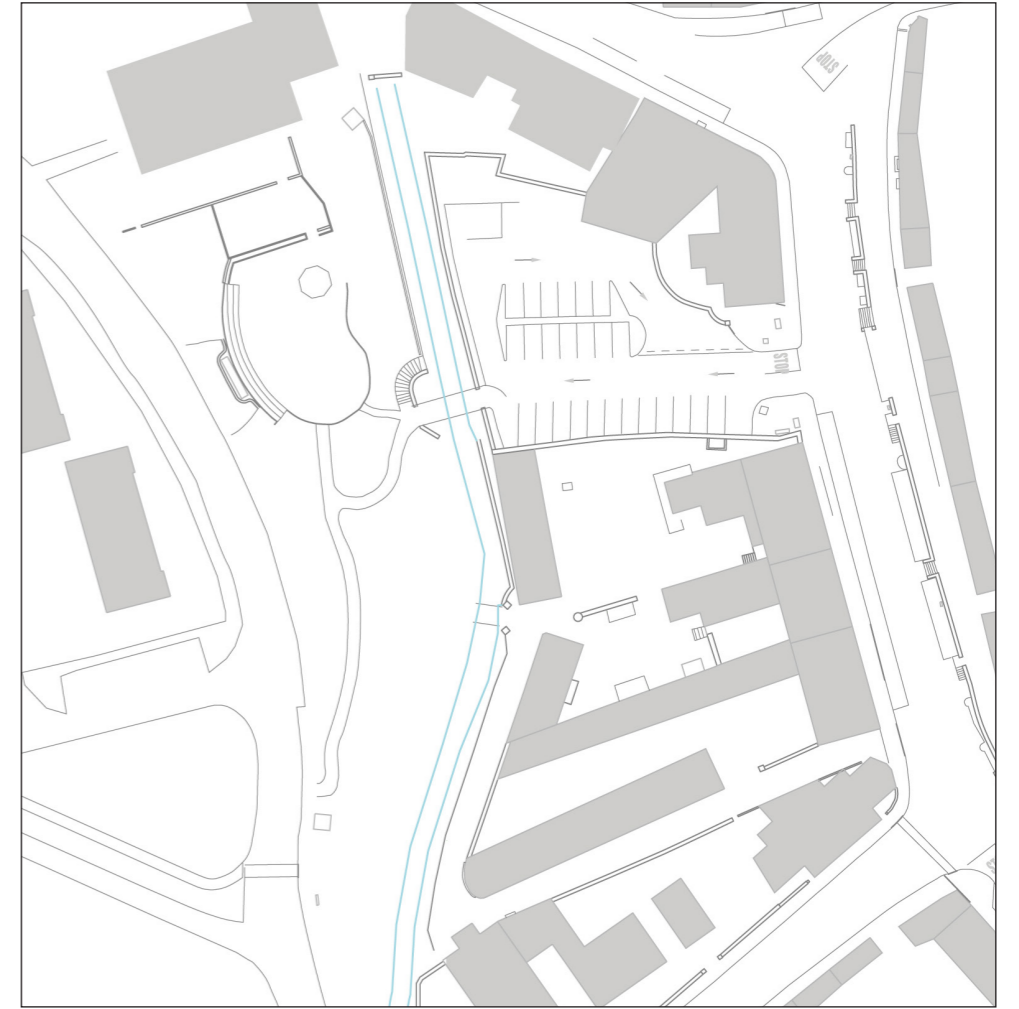

INTRODUCTION



1.1 INTRODUCTION

The aim of the Drumshanbo Town Centre Regeneration Project is to ‘tackle several key challenges that are hindering Drumshanbo’s economic, cultural, environmental, and social progress’.

The proposed development is located in the townland of Drumshanbo, Co. Leitrim, specifically the town centre of Drumshanbo on the main street. There are four core key strands:

- ExCHANGE Smart work facility
- Creative Exchange: The repurposing of the existing stone outbuildings 60m² to the rear of the EXCHANGE into two independent creative studio units.
- Regeneration of Riverside/Backlands Area
- Create a pop-up town centre food experience on Drumshanbo’s High Street

Landscape Objectives:

- Improve sense of place
- Improve permeability & connectivity
- Improve functions of under used open spaces
- Improve visual connections / intervisibility - between key areas, entrances & focal points



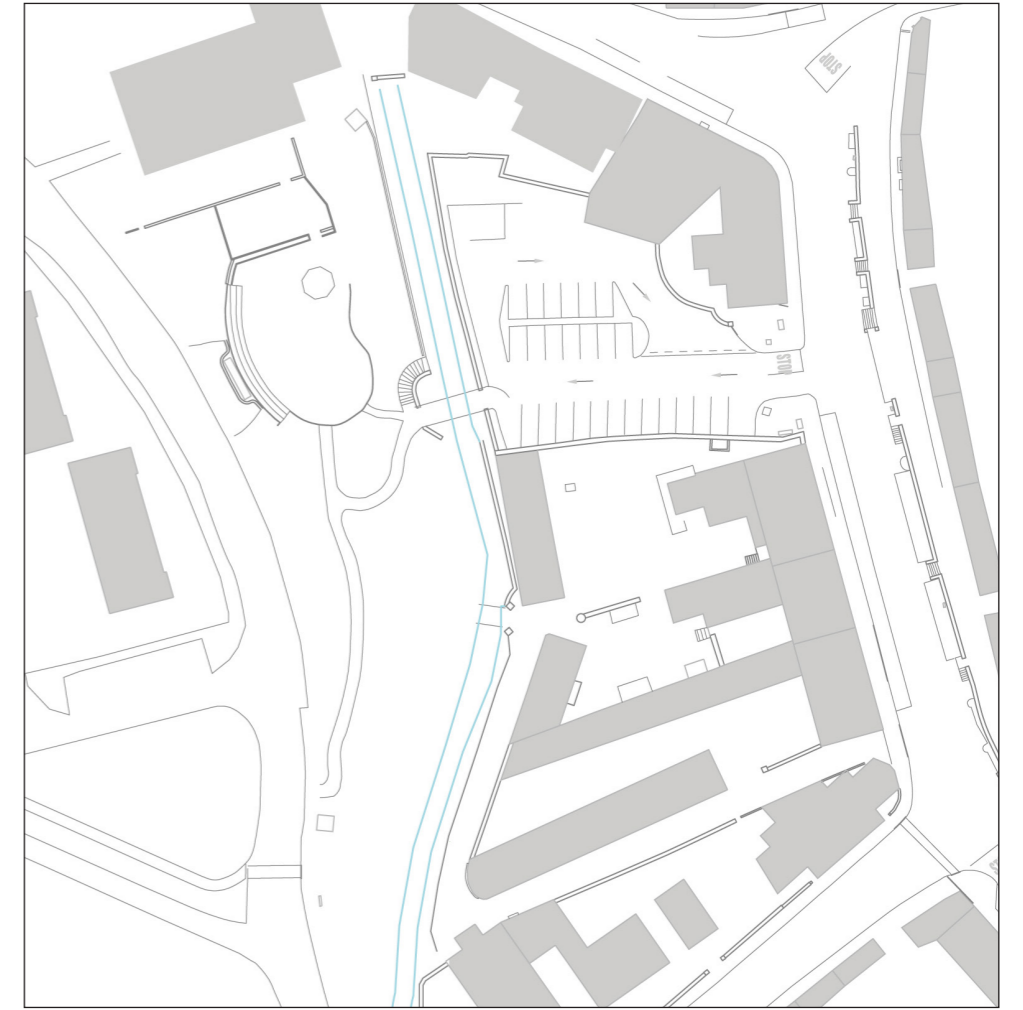

SITE ANALYSIS

2

2.1 Site location

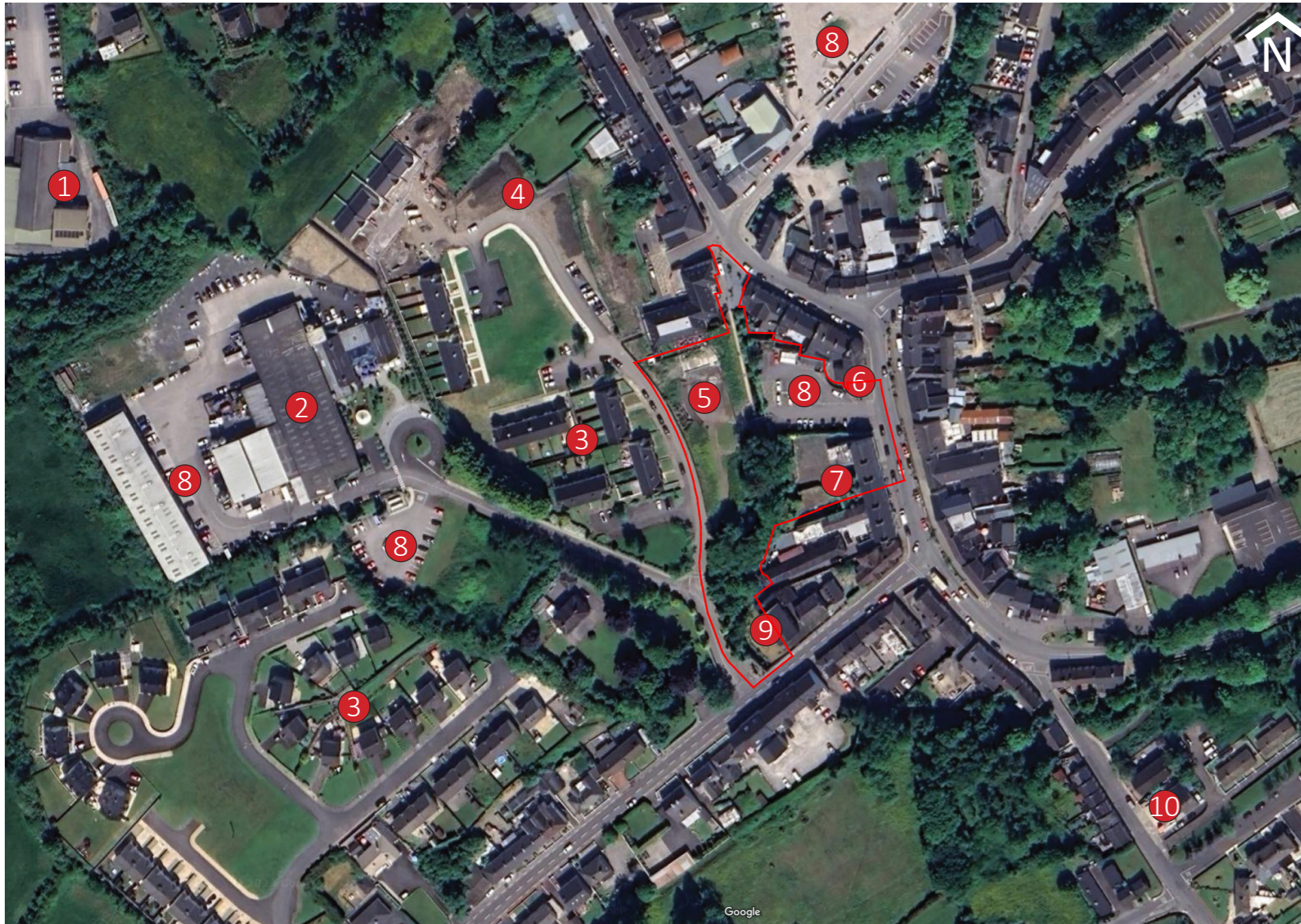

Drumshanbo Town Centre Regeneration Project Location:

- Central location within the town centre
- Attractive location along the river & overlooking The People's Park
- Existing car park & transport infrastructure

LEGEND

- ① Community Centre
- ② The Food Hub
- ③ Residential Area
- ④ New development
- ⑤ People's Park
- ⑥ Drumshanbo Library
- ⑦ Drumshanbo ExCHANGE project
- ⑧ Car parking
- ⑨ Drumshanbo Methodist Church
- ⑩ Fire Station

2.2 Permeability And Connectivity

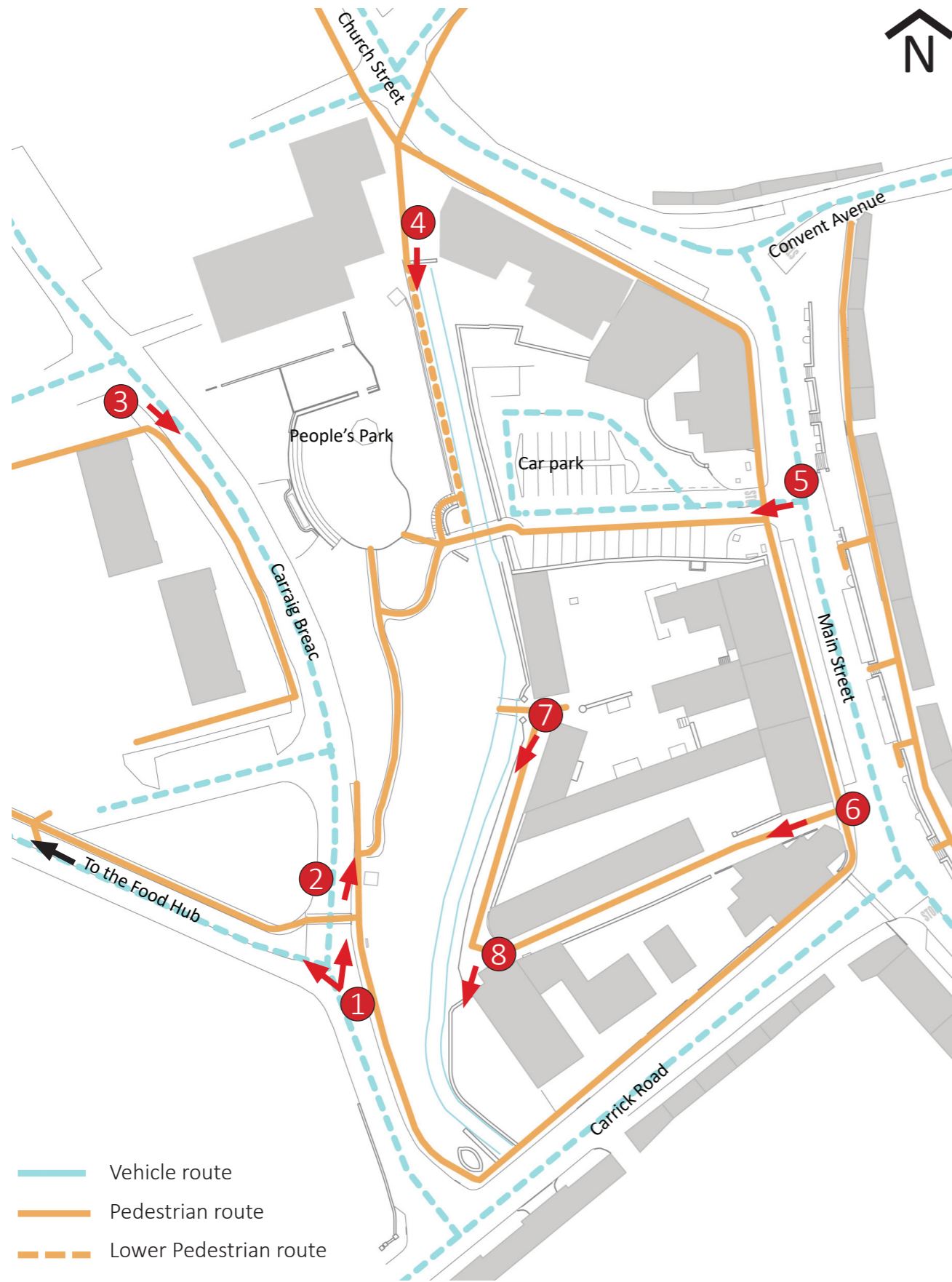

Strengths:

- Facilitates pedestrian link between the town centre & The Food Hub - bridge from the car park linking The People's Park - western park entrance at Carraig Breac.
- Riverside walk between the plaza to the north & stepped access into The People's Park- attractive amenity & provides visual & physical connection to the river.

Opportunities/ areas for improvement:

- Indirect route between the town centre & The Food Hub, could be improved
- Eastern entrance/ bridge to The People's Park- pedestrians & cars sharing the same space, no segregated pedestrian route- safety concern & less attractive option to pedestrians.
- Limited access to The People's Park and the town centre from the residential areas to the north, west & Carrick Road - may discourage frequent use of the park by residents living in close proximity to it.
- Pathway along western boundary of The People's Park terminates just after the park entrance- no segregated pedestrian route linking Carraig Breac to The People's Park, town centre & The Food Hub.



1 Pedestrian route from People's Park to The Food Hub. No pedestrian connection between residential area & The Food Hub



2 Access to the People's Park & termination of the pathway to the north. No pedestrian link between residential area & People's Park

3 Pedestrian route on residential side of the road within Carraig Breac

2.2 Permeability And Connectivity

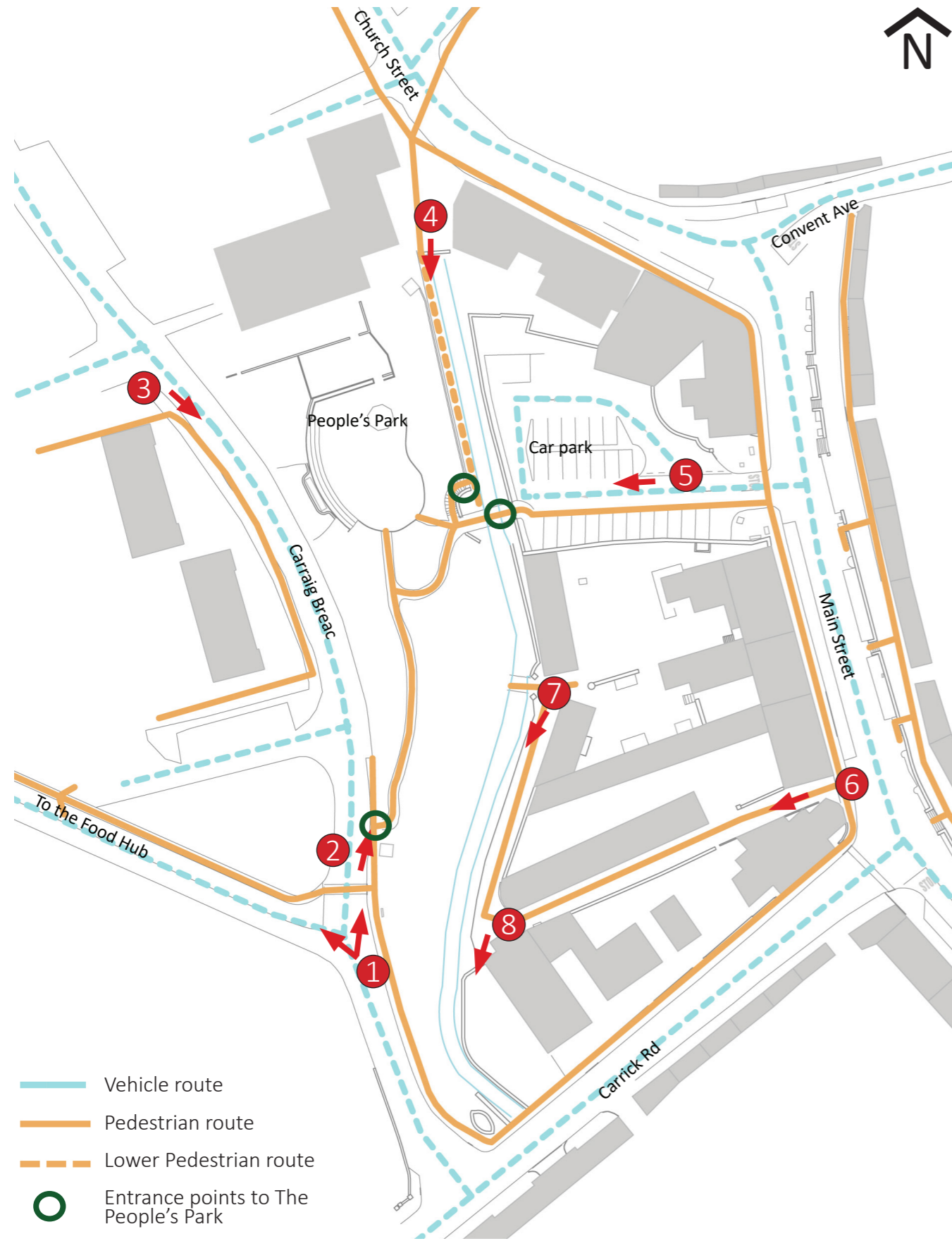

4 Access to The People's Park from Church Street



5 Eastern bridge access to The People's Park from the car park



6 Access to river walk from Main street



7 Pathway along the eastern side of the river



8 End of pathway at the back of the church

2.3 Existing Open Space Functions

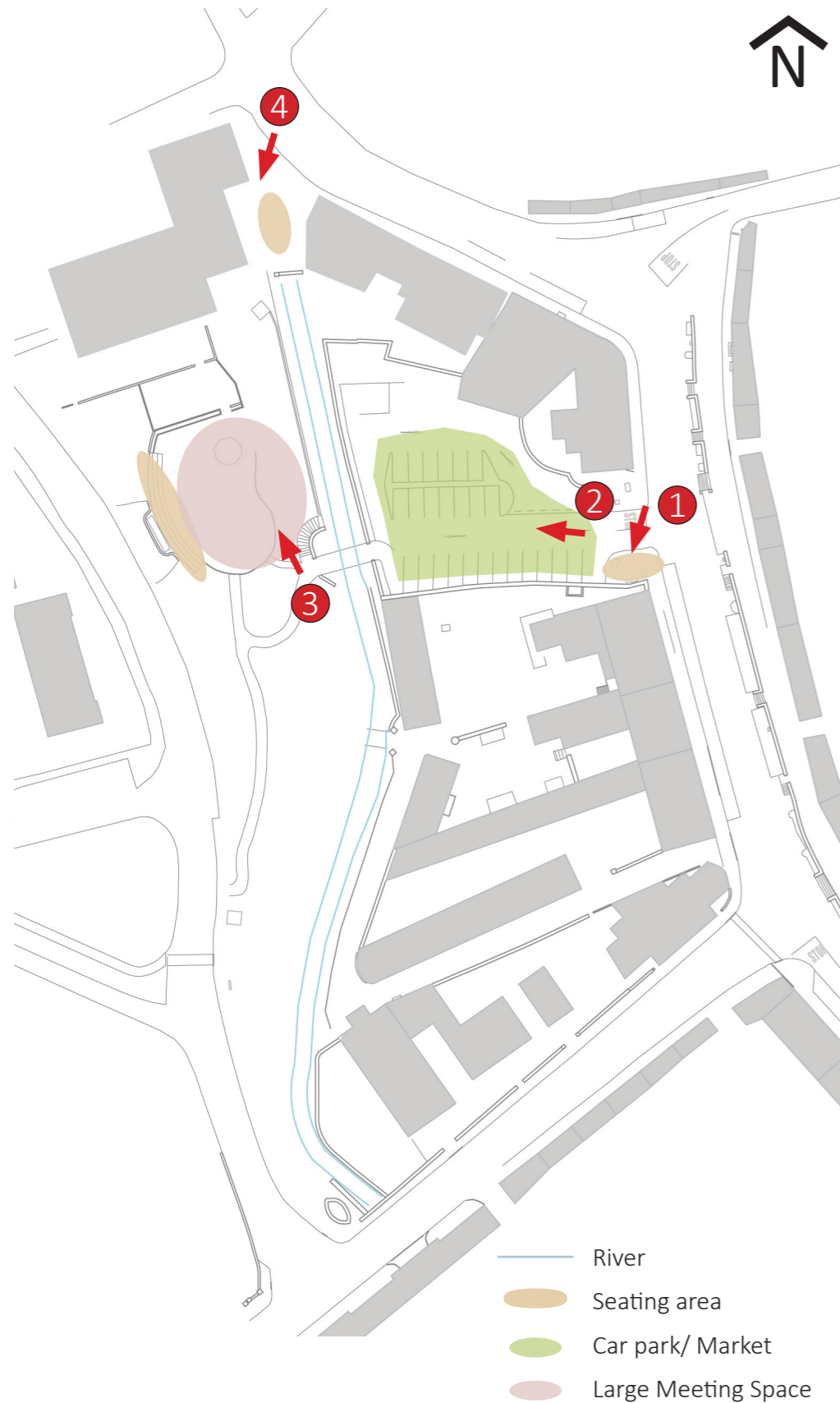

- View at entrance to the car park.
- Seating area
- Installation showing images from Drumshanbo's history



- View of the car park. Same area used as a market/ food stalls.
- Bridge in the background - linking the car park/ town centre to the open space to the west.

- Core of The People's Park - large open space for gatherings, performance with amphitheatre style seating & sculptural element.
- Facilitates views towards the town centre & wider landscape.
- Views towards Sliabh an Iarainn limited due to lower height of main open space & various boundary treatments.
- Unmaintained hard surface.
- Poor drainage to central space
- Lacks function outside of times of performance.



- View of the small plaza off Church Street, which includes seating & planting.
- This is also an entrance point to The People's Park via the riverside pathway & steps.
- The planting & boundary fence within The People's Park is visible from this location.

2.4 Topography

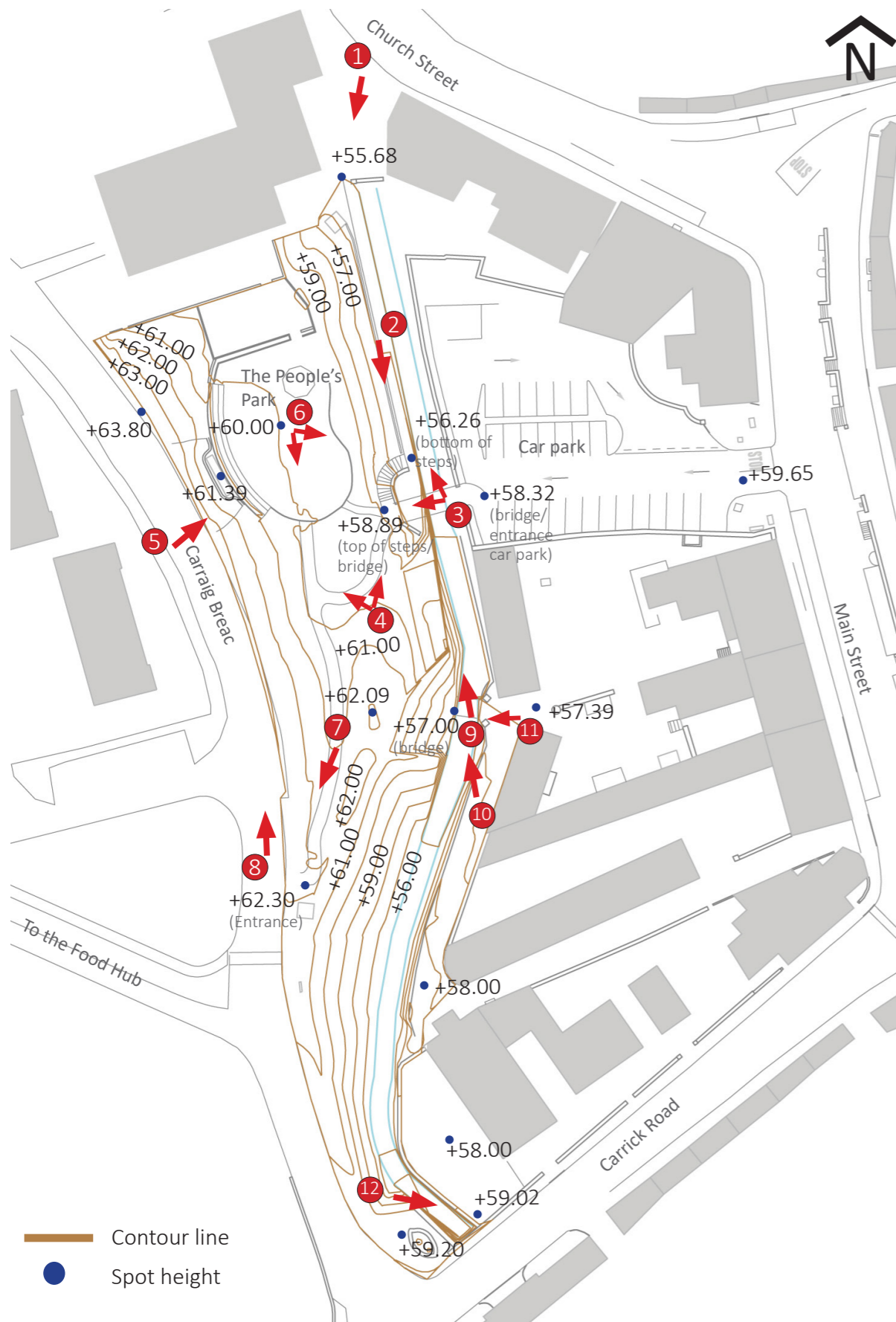

- Flat central open space
- Surroundings- steeply sloping, rising from the river westwards towards Carraig Breac.
- 6m level difference between lower path along river edge & entrance to The People's Park from Carraig Breac (west)
- Steep embankments along river edge
- Stepped access & ramps/ sloping pathways required to link various spaces: Town Centre- River- The People's Park- Carraig Breac
- The higher ground facilitates views over the town & wider landscape.
- Amphitheatre style seating cut into the embankment- utilised to address the level change from east to west



2.5 Existing Vegetation

- Riparian corridor - woodland planting with dense understory along river edge - prevents views of the river
- Dense planting & ground modelling- limits views of the river, pedestrian entrances from within the park
- Wildflower meadows within park- biodiversity benefits, attractive during spring & summer but little interest during autumn & winter
- Self-seeded trees & shrubs growing along & within the stone wall dividing the car park & the river- damaging to wall & limits views from the town towards the river & The People's Park.

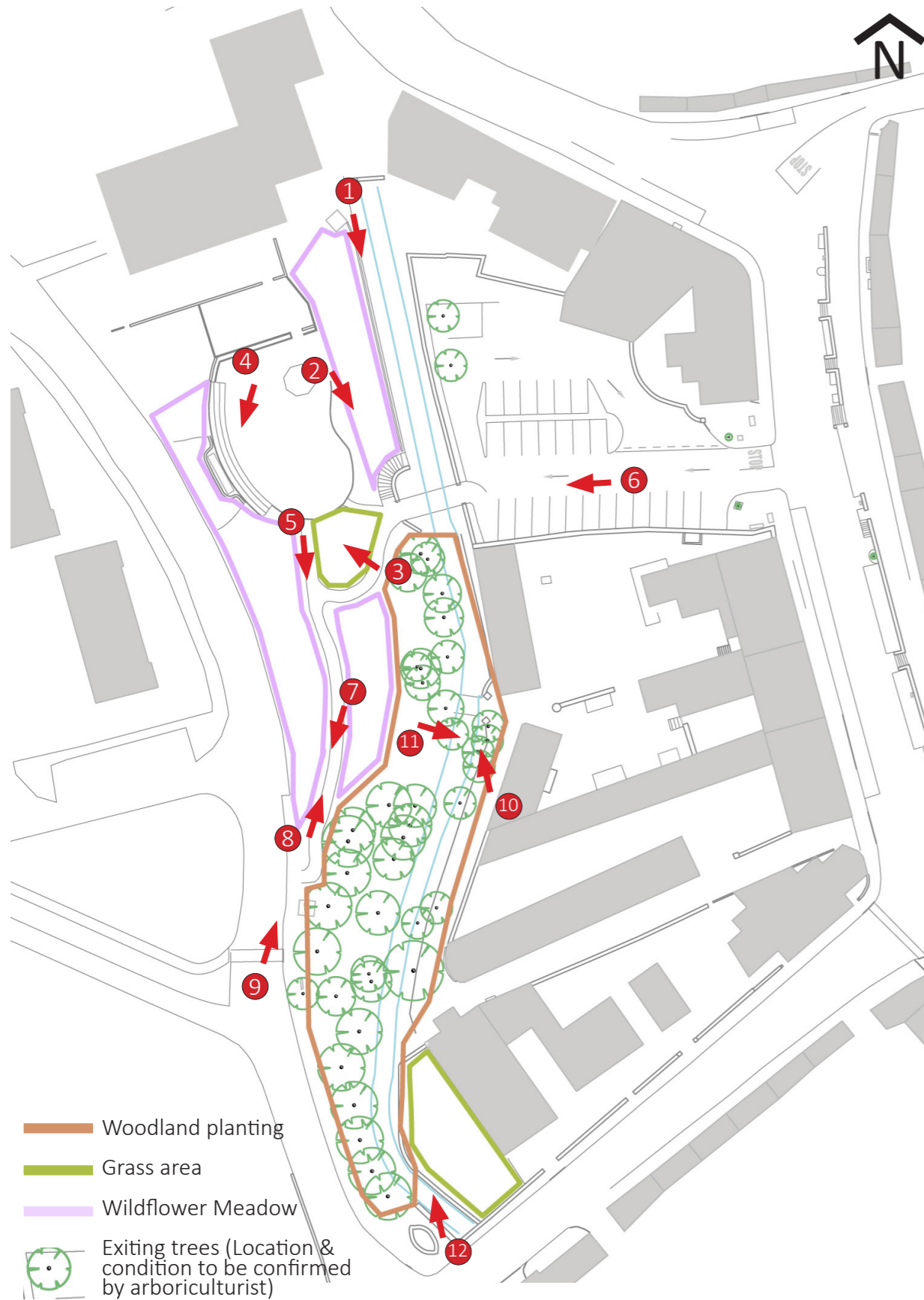

2.6 Existing Boundary Treatments

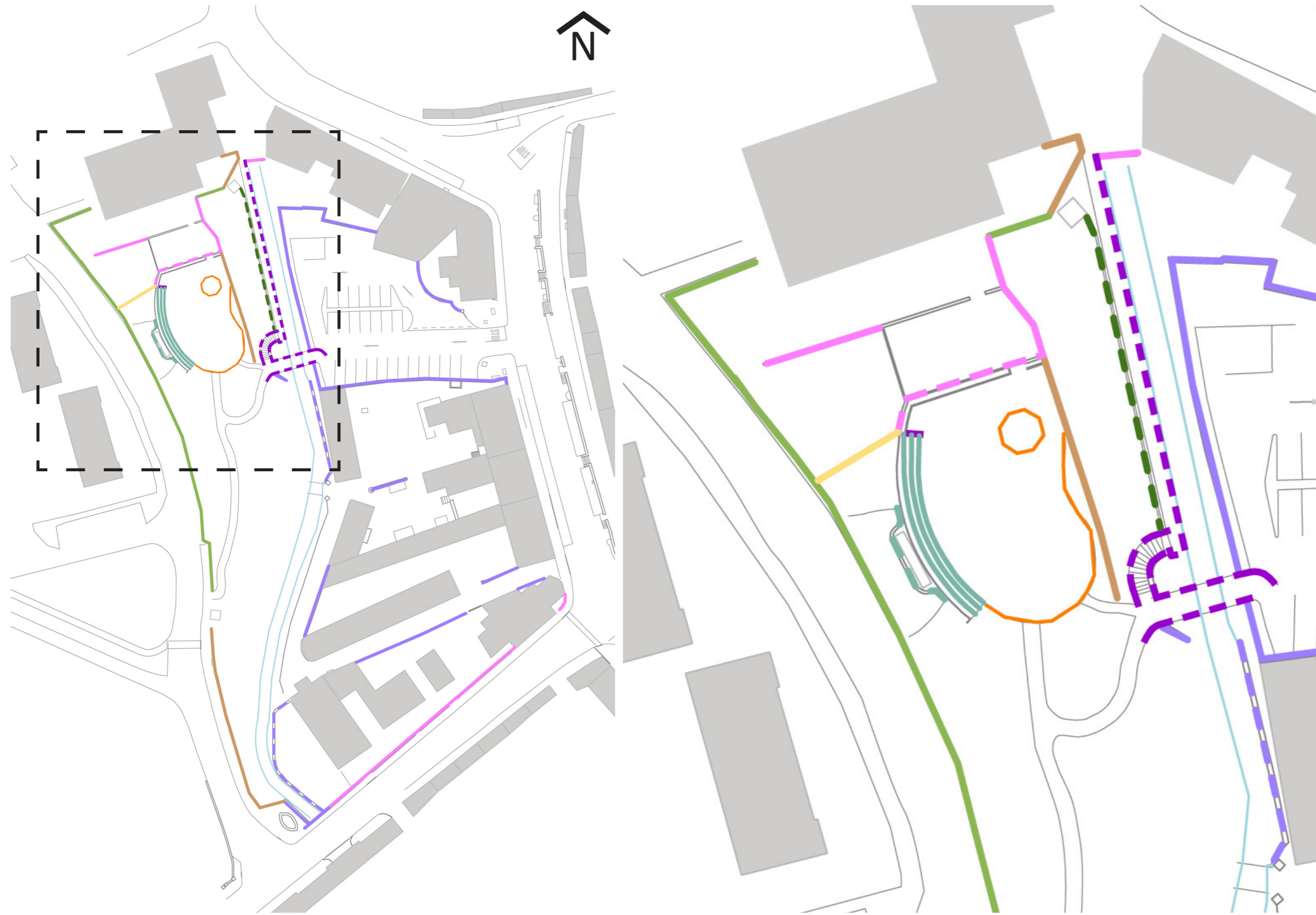

- Lacks visual cohesion - Variety of boundary treatments throughout this area- type, colour, material & height.
- Visual barriers - some boundary treatments limit views of the town/ wider landscape, such as the high timber fence that forms the western boundary to The People's Park (prevents views towards Sliabh an Iarainn).
- High stone wall with self-seeded trees/ shrubs limits the visual connection between the town centre & The People's Park

- Stone wall
- - Stone to stream channel
- - Metal railing
- Timber post and timber rail fence
- Low plinth wall with railing
- - Low plinth wall with railing (with Concrete planter)
- Picket style timber fence
- Timber panel with concrete post
- Brick edge
- Retaining wall
- - Retaining wall with seating
- Timber Sleeper

2.6 Existing Boundary Treatments

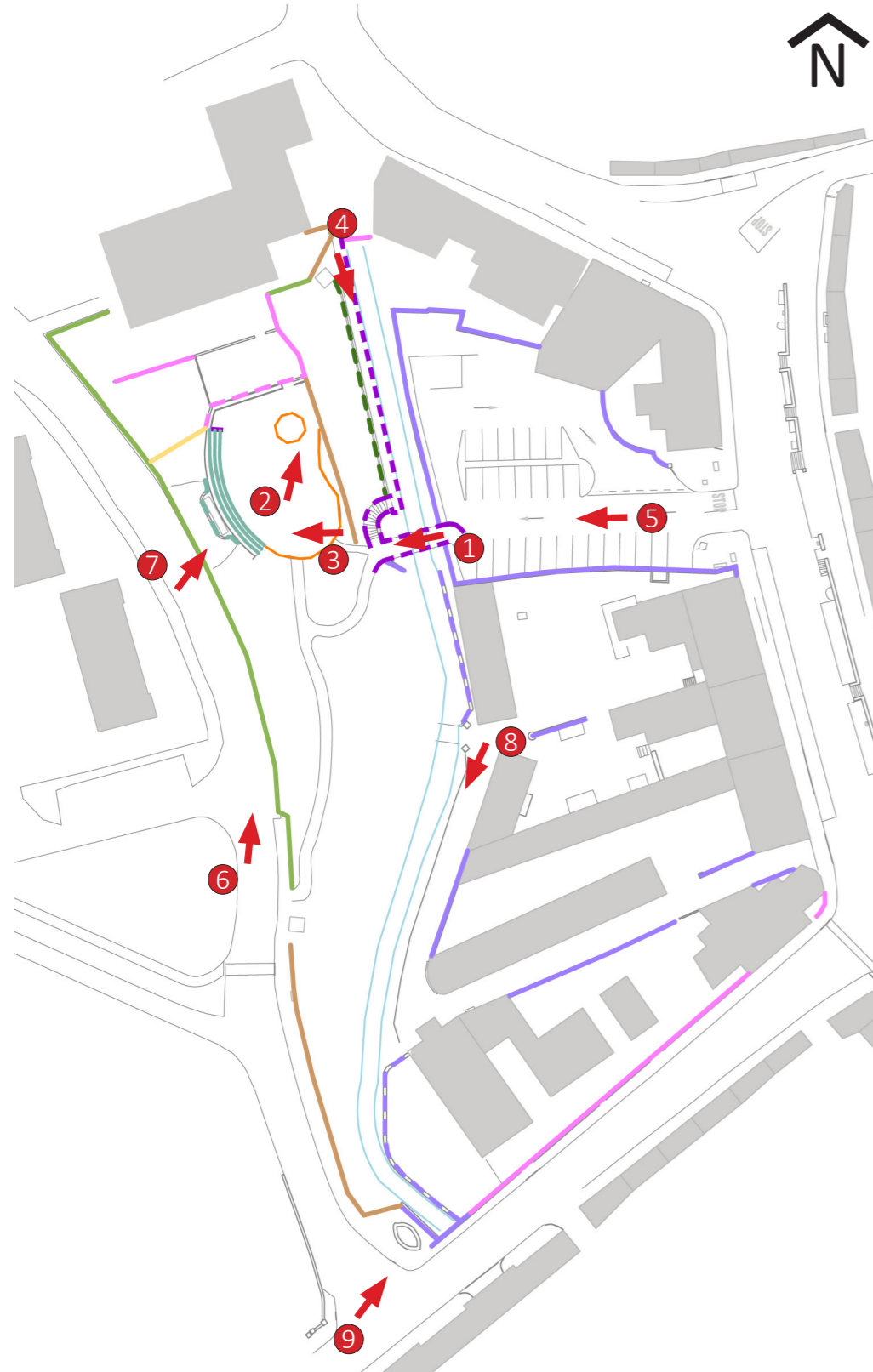

2.7 Visual Connections - Intervisibility

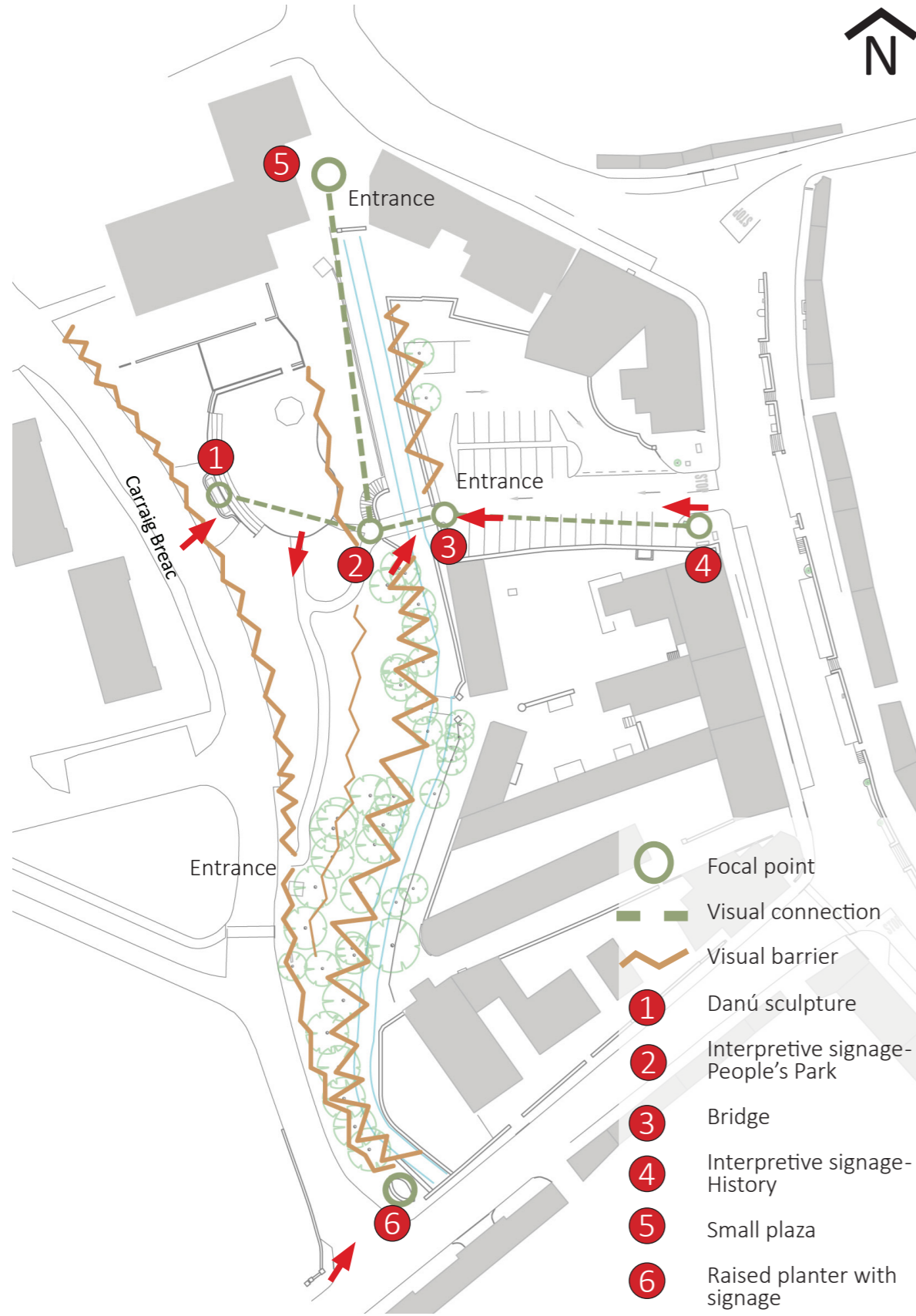

Boundary treatments- visual barriers



Car park & boundaries - limiting visual connections



High fence- visual barrier.
Good intervisibility between plaza & steps to bridge



Wall & overgrown areas - limiting visual connections



Dense planting- limiting views of the river & visual connection to riverside pathway & The People's Park



Low canopy of trees & undergrowth - limits visual connections between the park- entrance- river



View through gap in the timber fence along Carraig Breac. Fence prevents views towards the wider landscape & appreciation of the visual link with Danú sculpture & Sliabh An Iarainn

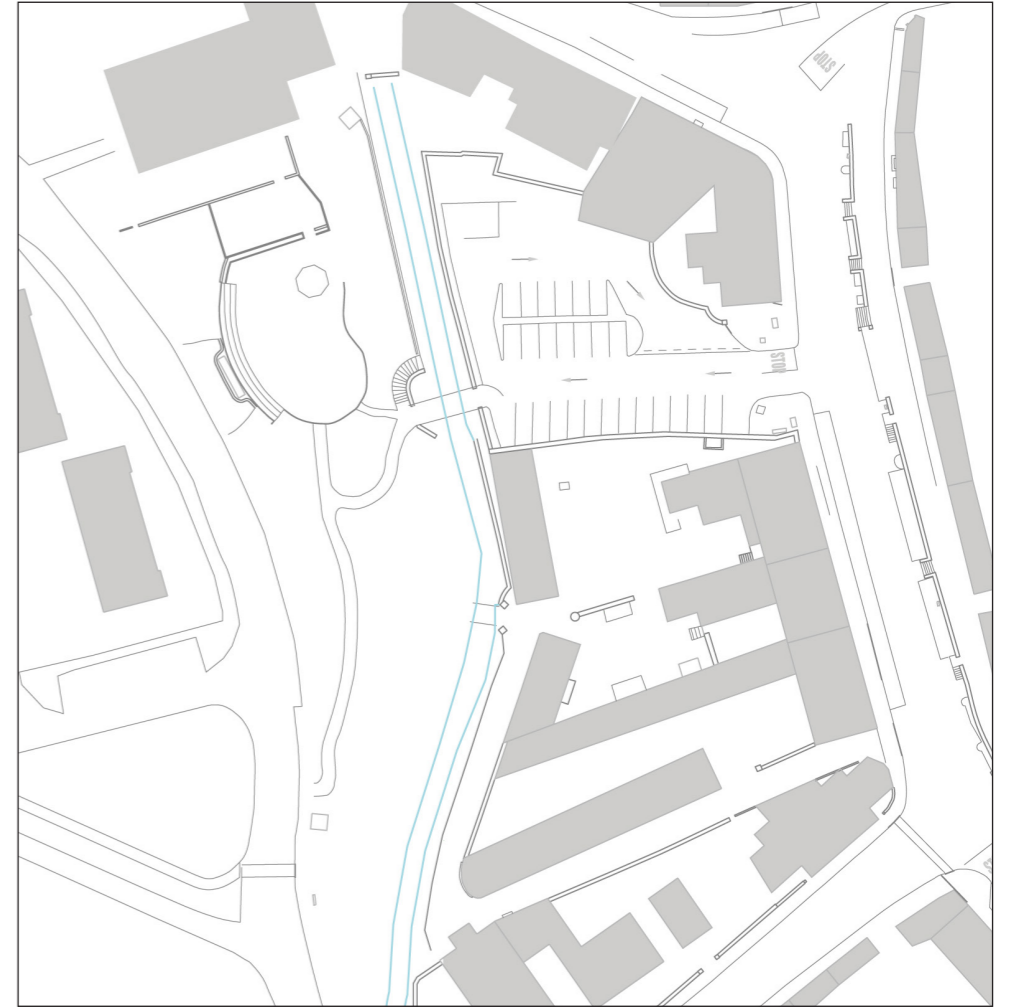

**CONCEPT
VISION**

3

3.0 DESIGN RATIONALE

The design approach to the external spaces is to produce high quality spaces with a **strong identity** and **distinctive sense of place** with strong linkages to nature (river & wider landscape) and the established communities.

It is intended that this can be achieved through careful design considerations including:

- **Improving Permeability & Connectivity** -
 - Enhancing pedestrian routes to & within The People's Park.
 - Providing pedestrian links to the ExCHANGE site - town centre - residential developments
 - Enhancing the pedestrian link between the town centre & The Food Hub.
 - Improve town centre connection with the river
- **Improving Open Space Functionality** -
 - Open space are responsive to diverse needs, evolving with the community and accommodating various activities and events seamlessly.
 - Adaptable space within the ExCHANGE project promotes food experience in the town centre area.
 - create spaces that provide more opportunities for people to play, socialise or relax within
 - provide more opportunities for people to appreciate the river & views of the wider landscape that The People's Park affords.
- **Improving Visual connections , Intervisibility**

Design integrates elements that celebrate the unique cultural identity of the town such as:

 - The relationship between the Danú Sculpture & Sliabh an Iarainn,
 - incorporating local aesthetics, materials, and historical reference.

Well defined and overlooked public spaces permits passive surveillance.
- **Nature-based design** - SuDS features such as:
 - Permeable surfaces
 - Blue tree pits
 - Bio-swales are to be incorporated and planted with the appropriate species that will be sustainable and thrive in these conditions.



3.1.1 Landscape Strategy - Improving Permeability & Connectivity

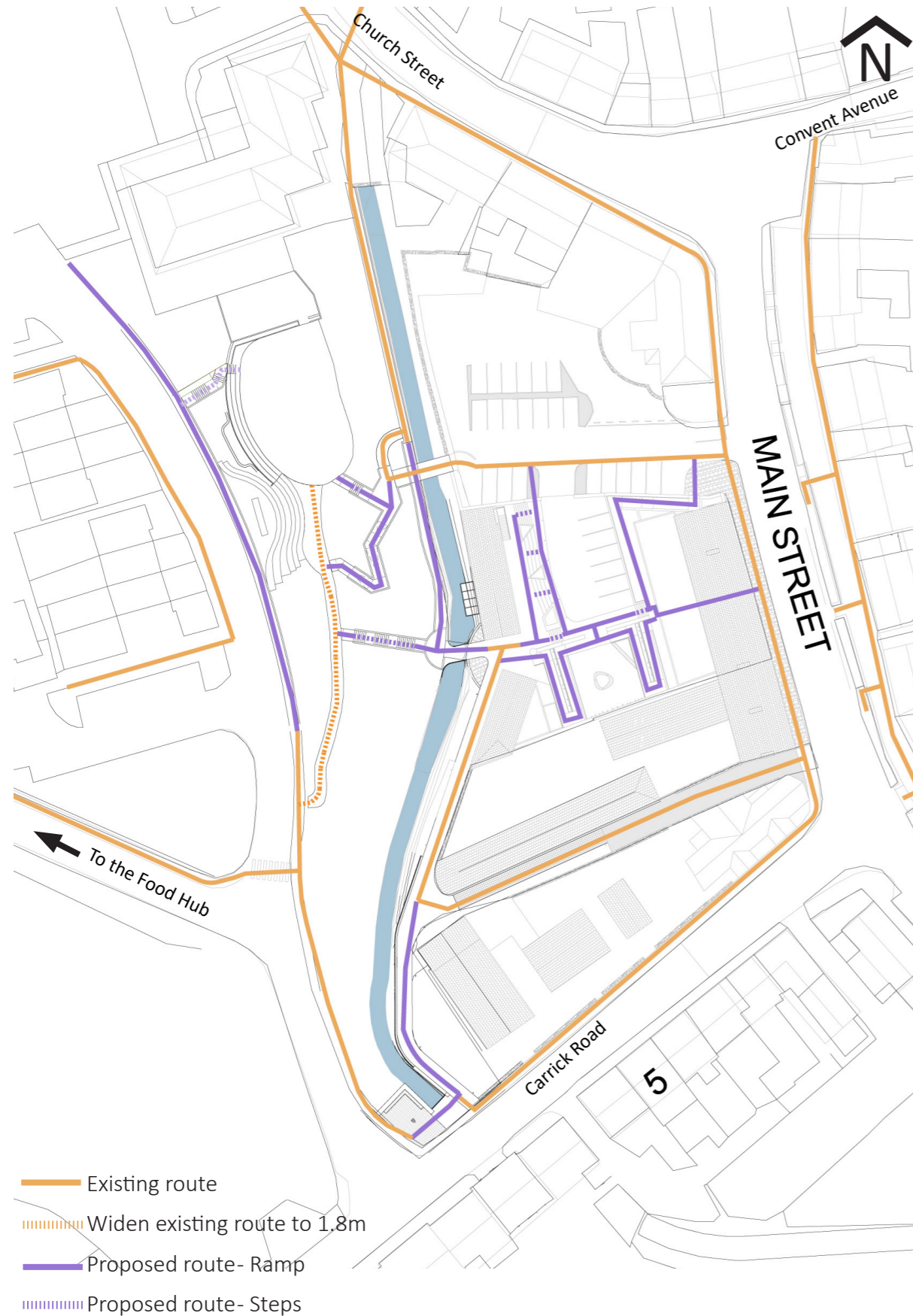

Objective: Improve connectivity with The Food Hub, The People’s Park, the town centre & the Drumshanbo ExCHANGE site.

Proposed Changes:

- Pedestrian route through the existing doorway/ Drumshanbo ExCHANGE building through to a small plaza/ event space- stepped route
- Pedestrian route through car park to People’s Park entrance - introduce road markings & distinct colour for the pedestrian route
- Pathway connecting the ExCHANGE site to the river edge
 - connecting to riverside pathway
 - connecting to The People’s Park (at the location of the existing bridge)
- Stepped route - connection to the upper pathway within The People’s Park
 - access to playground/ event space/ seating
 - entrance at Carrig Breac- link towards The Food Hub
- Pathway linking Carrick Road, bridging the river into the community building (former Methodist’s Church) lands & linking onto the riverside pathway to the rear of this building
 - improving link between Carrick Road- river- park- ExCHANGE site- Church Street
- Pathway on the park side of the road within Carrig Breac & stepped access into The People’s Park
 - improving link between Carrig Breac (& future development to the north)- People’s Park - river-- ExCHANGE site- town centre
- Widen the existing pathway (min. 1.8m) and re-grade to make it an accessible route (max slope 1:20) from the park entrance at Carrig Breac to the central open space- more attractive & comfortable space for people to move through
- Stepped route - more direct links between various spaces & can also contain a channel for bikes to improve connectivity

Disadvantages:

- Not including a ramped pathway linking the ExCHANGE site to upper park pathway - less inclusive access & amenity for users
- Less direct route between the town centre/ ExCHANGE site & The People’ Park.



3.1.1 Landscape Strategy - Improving Permeability & Connectivity

Alternative accessible routes

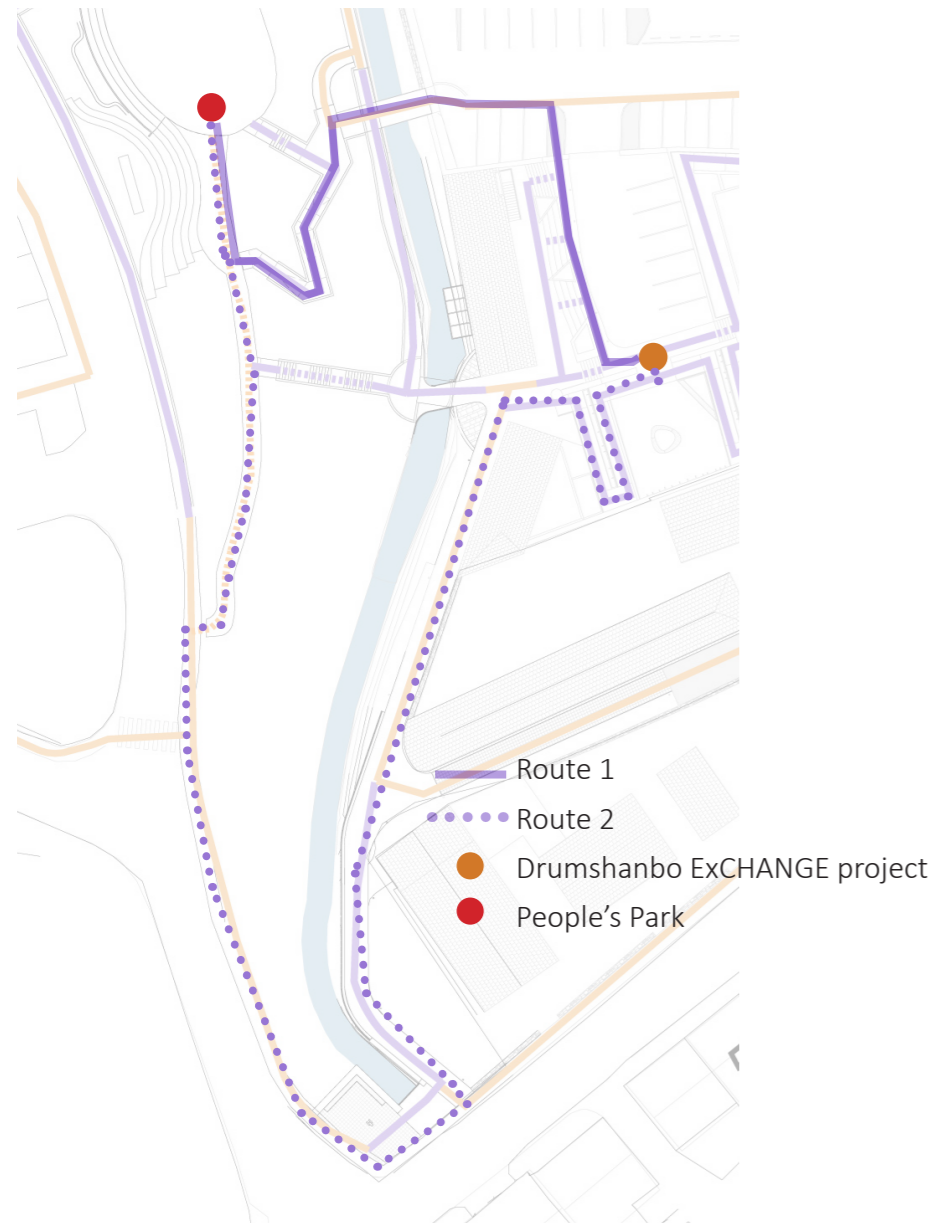

Accessible routes:

As an alternative to the stepped route which provides a more direct link to the ExCHANGE site to the central open space & the upper park pathway, the alternative **accessible routes** are:

- Route 1:
 - Ramp in the ExCHANGE project- New car park/ market area- car park- park entrance- bridge- ramp- play area in the People's Park
 - Length (approx): 100m
- Route 2:
 - Riverside walkway on ExCHANGE side- community building (former Methodist's Church) lands - bridge- route along street- entrance at Carraig Breac side- ramp- play area in the People's Park
 - Length (approx): 230m

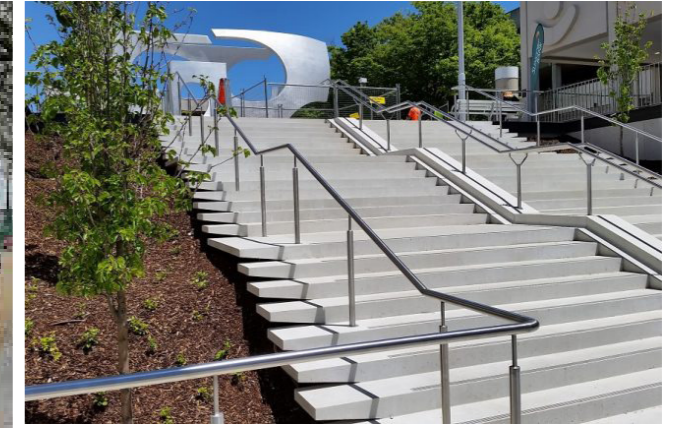

Pedestrian link through the car park to The People's Park

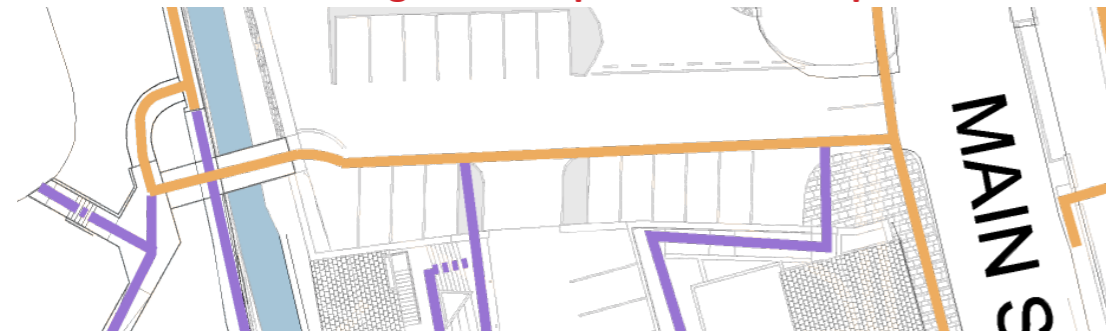

Improving pedestrian link between the town centre, through the car park to The People's Park & beyond

Surface markings, distinct surface materials & colour - alert driver that this is a shared surface & pedestrian movement should be prioritised

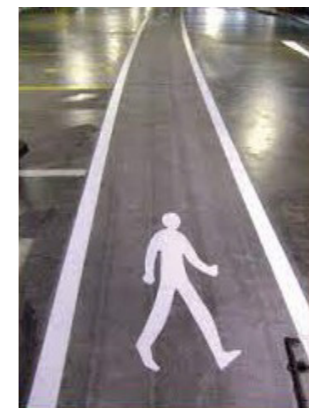

3.1.2 Landscape Strategy - Improving Space Functionality



The design strategy is to produce an area with a strong identity and distinctive sense of place. It is intended that this can be achieved through carefully designed usable spaces with varying character, dynamics and emphasis. Through providing visually attractive spaces the local community & visitors to relax, move and/ or socialise within, it assists in defining areas and reinforcing the character of the various spaces such as the proposed play and recreational area, the market areas etc.

- **Seating area:** Seating areas are also proposed along the pathways to allow people to rest, appreciate the riverside setting and as a meeting place.
- **Play area:** A variety of play equipment aimed for 4+ children are proposed within the People’s Park for active and group play with natural play elements. It is proposed to combine with the local culture and nature elements such as Sliabh An Iarainn, Danú sculpture. Permeable safety surface is proposed to the play areas, in order to provide the recommended safety measures while also retaining the natural aesthetic of the Park’s setting, also solve the current poor drainage issue.
- **Events space :** These areas provide spaces for people to gather, performance and events.
- **Car park/ Market area:** This area proposed more car park spaces and can be used for occasional food markets/ events.
- **River walk area:** It provides waterfront walk with railings experiences for the people.
- **Car Park:** The existing car park will be retained, incorporating blue tree pits (SuDS) where space allows, swale along western boundary and delineation of the pedestrian route from the town centre towards the park.

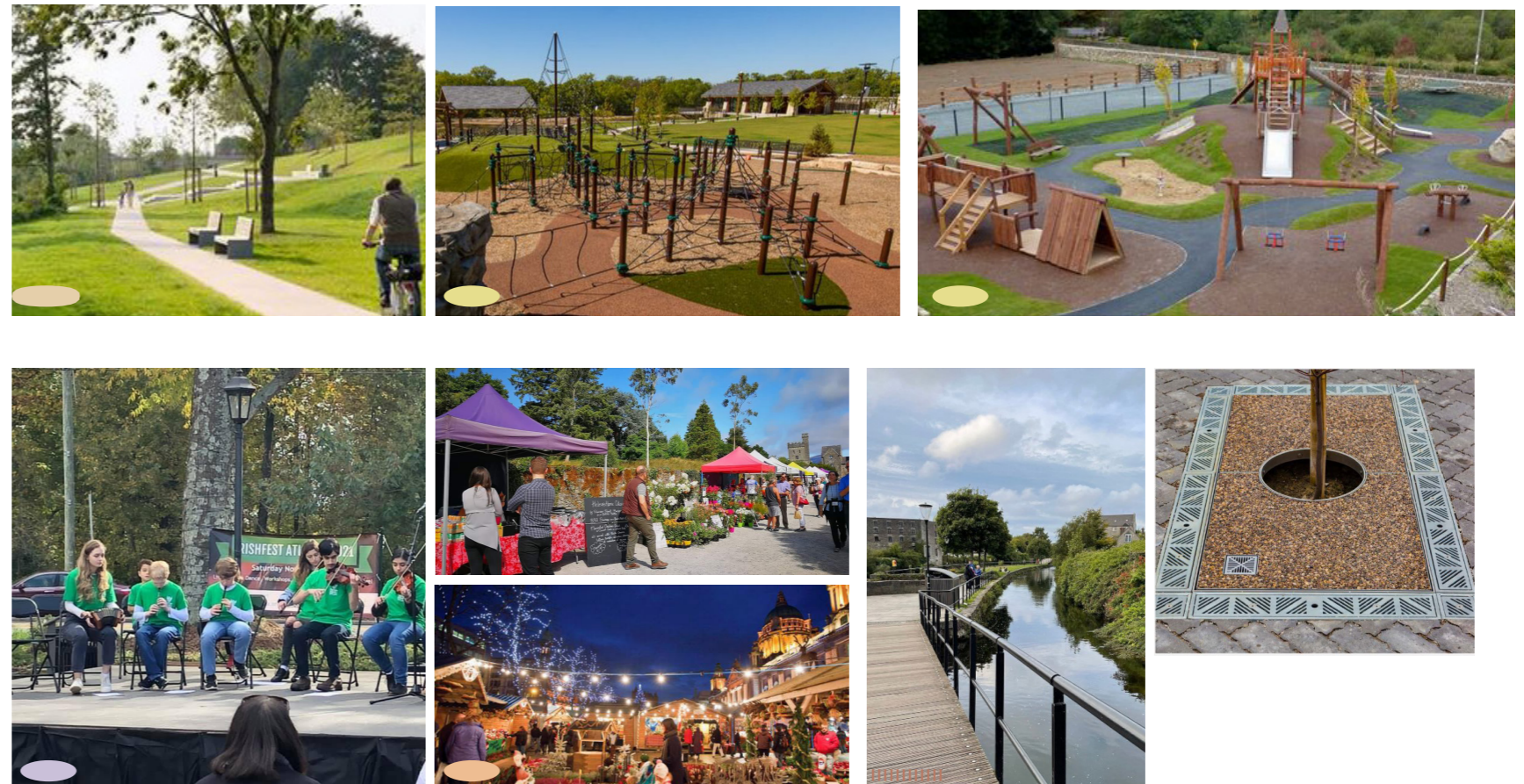

3.1.3 Landscape Strategy - Existing Vegetation & Proposed Planting

Existing vegetation and proposed planting



Existing vegetation treatment

- Crown lifting of existing trees (remove lower branches) and pruning/ removal of larger understory planting on embankments - open views towards the river, along pathways and allow passive surveillance
- Re-profile ground modelling - open views of the river, pedestrian entrances within the park
- Remove of self-seeded trees & shrubs growing along & within the stone wall dividing the car park & the river- allow view towards the river and People's Park

(Refer to the arboriculturist's report & survey for full details of the existing trees & vegetation)

Proposed planting

- Native Specimen trees - create a more aesthetic and attractive natural landscape
- Sensory planting within the play area - allow people to explore and learn about plants while stimulating senses in a controlled and relaxing environment
- Riparian planting along river corridor with native species - enhance ecosystem resilience, and fosters biodiversity
- Introduce swale/ bio-retention area, to edge of car park- SuDS
- Blue tree pits in the car park-SuDS
- Hedge planting along the north boundary in the park - screen the timber panel fence and plinth wall with railing boundary
- *Refer to landscape drawings 300 & 301 for further details*



Concept images



3.1.3 Landscape Strategy - Improving Visual Connections - Intervisibility

Boundary treatment

- Improve visual cohesion- Unify boundary treatments throughout this area- type, colour, material & height.
- Remove visual barriers- Replace boundary treatments or lower the height to allow views of the town/ wider landscape



Replace fence with guardrail (Black)

- Permits views into the park and provide passive surveillance from residential area
- Permits wider landscape views



Wider landscape views after replacing the timber fence to guardrail



Paint existing pink railing to black

- Match the new boundary treatment



Paint timber fence to black and add hedge planting to screen the boundary



Remove brick edge, change timber fence to guardrail (Black)

- Match the new boundary treatment



Lower the stone wall and add swale to the front

- permit view to People's park



Paint existing pink railing to black
Proposed riverwalk railing continues the type



Concept images
Guardrail type and color

3.1.3 Landscape Strategy - Improving Visual Connections - Intervisibility

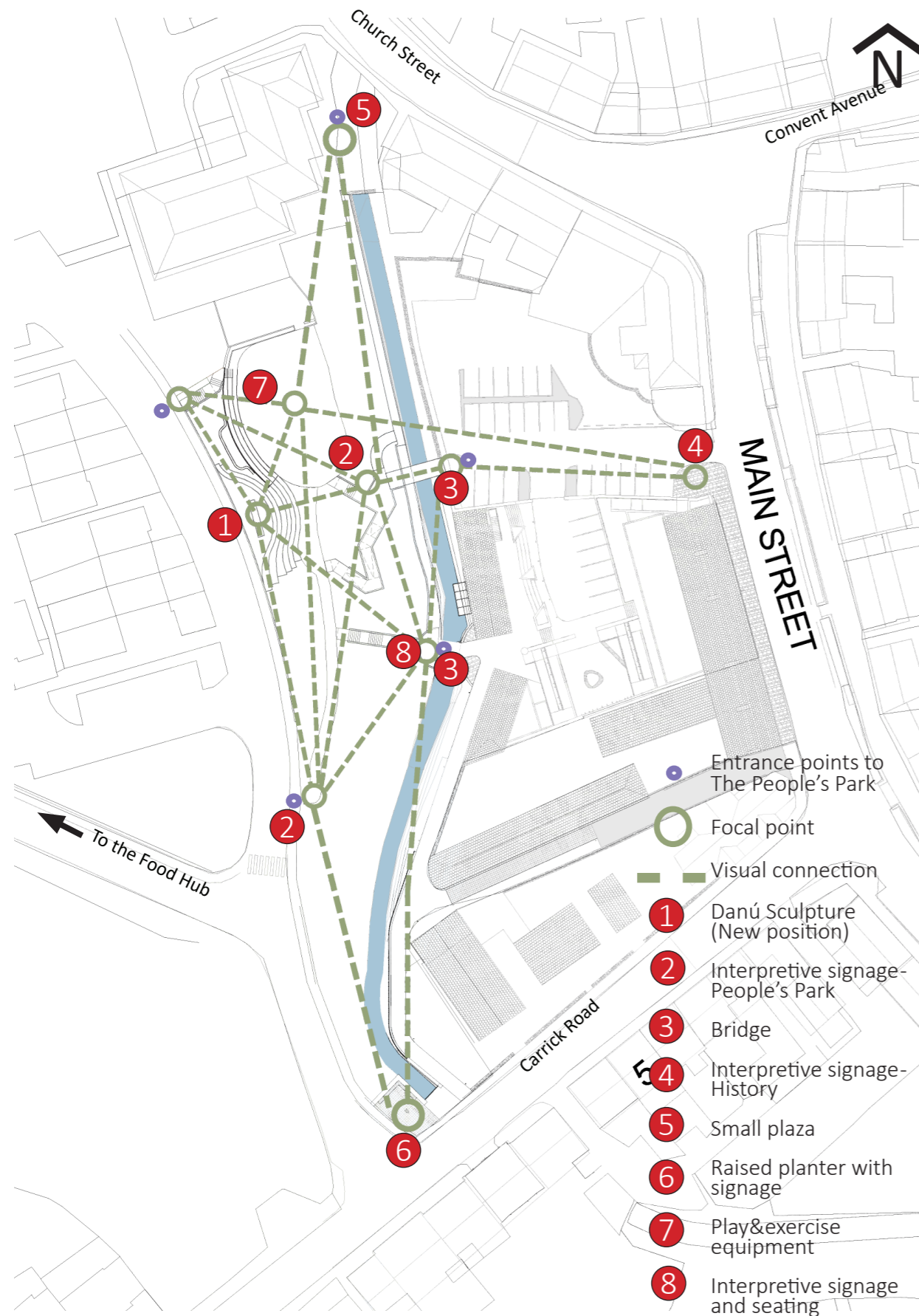

- Lifting tree crowns, removal of understory planting, re-profiling ground
- Improve boundary treatment
- Introduce new focal points
- create well defined and overlooked public spaces
- Relocate the location of sculpture Danú to south of the original location and higher level, continue seating with original one, provide wider view of furthur landscape
- People can step up which connects the view of Danú sculpture and Sliabh an Iarainn.
- create the visual connectivity from car park- bridge- Interpretive signage- Sculpture
- It provides seating area for the proposed Events space
- Ensure the integrity of the space and preventing disruption to the play area



Wider landscape views after relocate the Danú Sculpture

3.1.4 Landscape Strategy - Nature based design

Nature within the design of the public realm

SuDs

SuDs measures are successful in cleaning and attenuating surface water runoff. SuDs feature can be successfully incorporated into the design of public spaces using water engineering solutions. Examples include: bio retention areas and constructed tree pits incorporating water retention.

Seasonal colour and shade

Seasonality of street trees and planting along routes and within public spaces provides greater visual delight and enjoyment.

Climate change

Climate change is creating warmer, drier summers creating a greater requirement to provide shade from harmful UV within the public realm.

Practical amenity of nature based spaces

Carefully designed nature based spaces provide further reason for people to visit their town centre and encourage them to stay longer when they do.

Healthy Street Trees

Street trees can have a real and lasting positive impact on the local community well-being. Careful species selection, along with well considered tree pit detailing are key to providing healthy trees in an urban environment.

Urban Meadow

Meadows provide colour, enhanced biodiversity and a naturalistic, informal aesthetic to urban spaces, particularly in the summer months. They also have a lower maintenance requirement over lawn areas.



Midtown Center Plaza, Washington, DC, USA

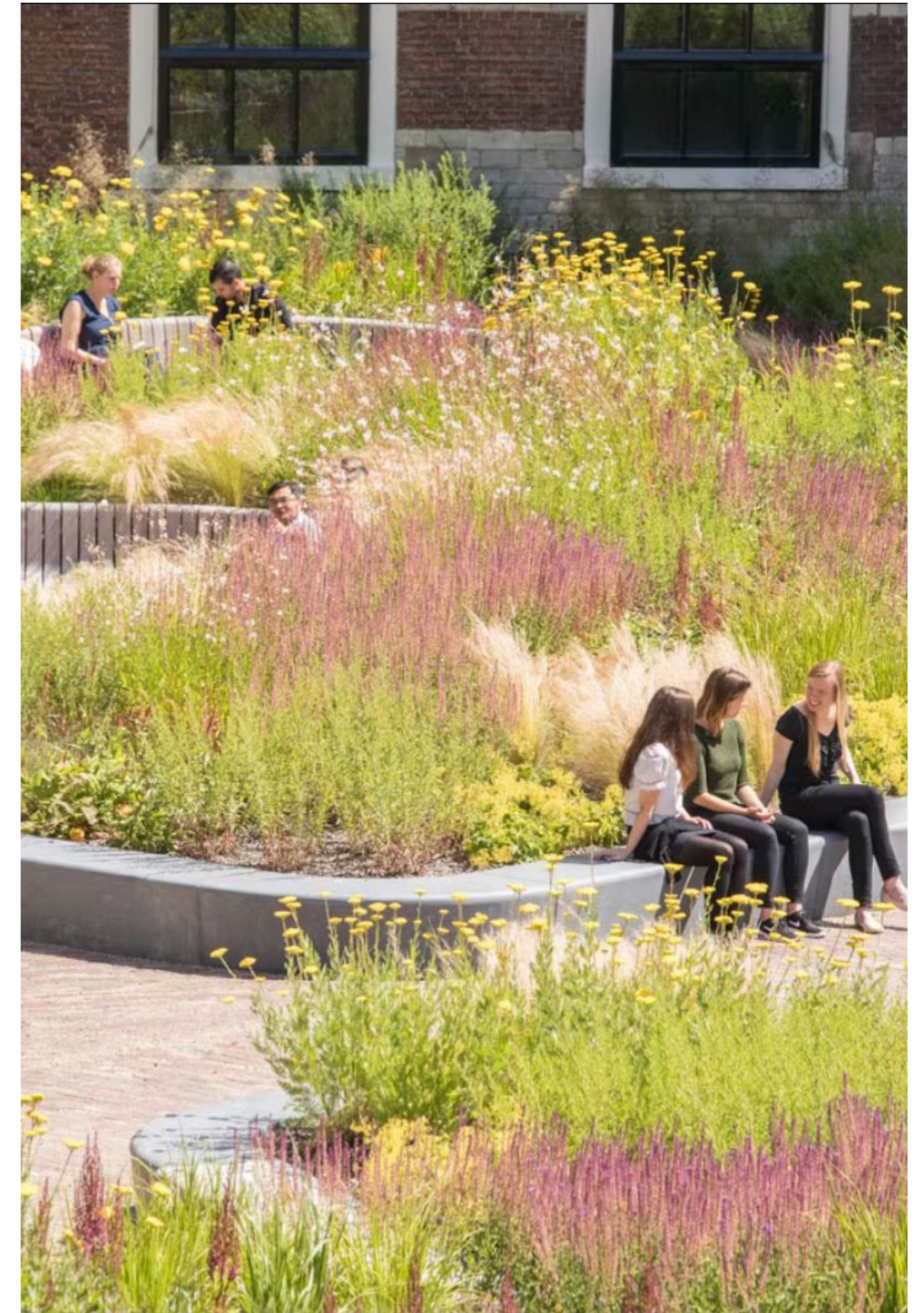

Delfand Water Authority, Delft, The Netherlands

3.1.5 Landscape Strategy - Plan



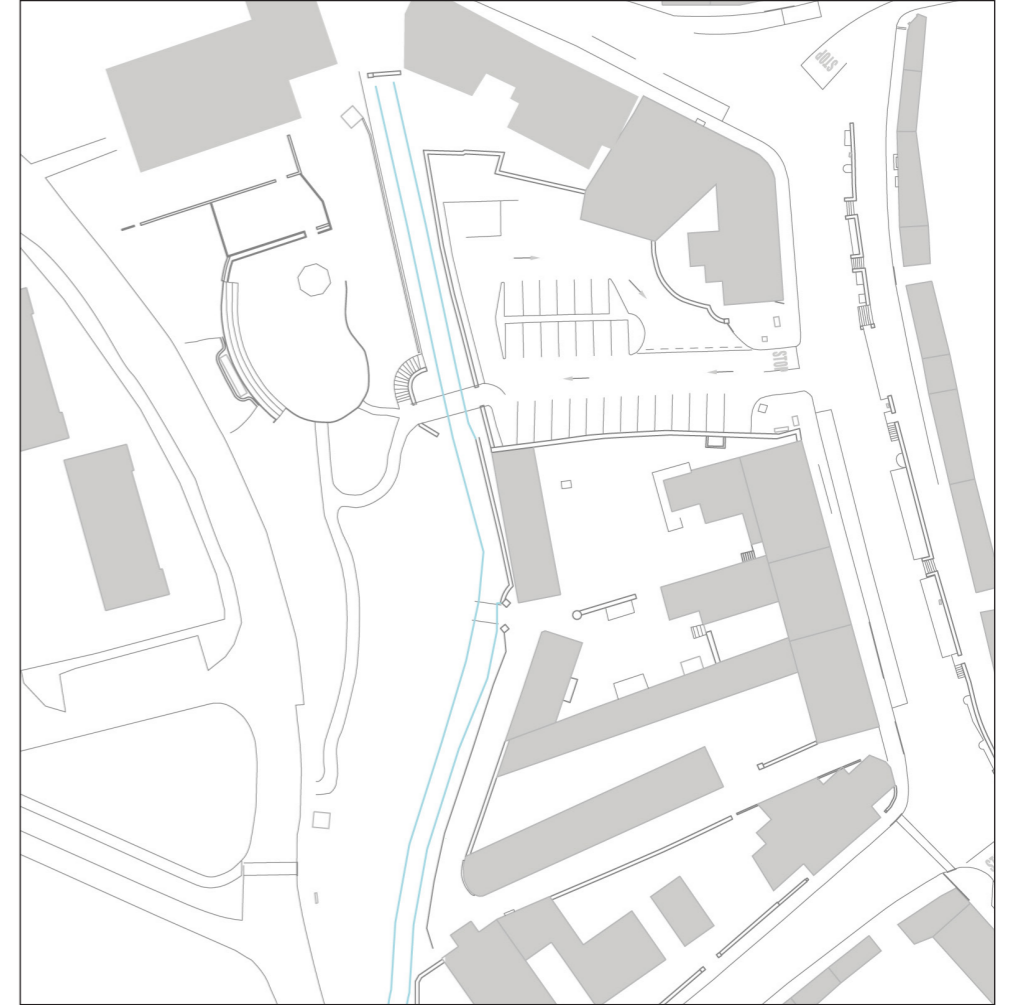

Landscape Proposals

4

4.1.1 Overall Landscape Plan



Legend

PROPOSED TREES & SOFTWORKS

- EXISTING VEGETATION RETAINED (all trees & hedgerows to be retained and removed as per arboricultural assessment)
- EXISTING TREES & HEDGEROW TO BE REMOVED (all trees & hedgerows to be retained and removed as per arboricultural assessment)
- PROPOSED LARGE SPECIMEN TREE PLANTING (approx. 7.5m high)
- PROPOSED PARKLAND/ MEDIUM TREE PLANTING (approx. 6m high)
- PROPOSED STREET TREE PLANTING (approx. 5m high)
- PROPOSED MULTI-STEM/ SMALL TREE PLANTING (approx. 2.5m high)
- PROPOSED NATIVE HEDGE PLANTING
- PROPOSED HERBACEOUS PLANTING
- PROPOSED RIPARIAN PLANTING
- PROPOSED PLANTING TO BIO-SWALE
- PROPOSED AMENITY GRASS AREAS
- PROPOSED WILDFLOWER/ NATIVE GRASS AREAS

PROPOSED HARDWORKS

- PROPOSED LIMESTONE PAVING
Dims: 600x300, 600x400, 400x400, 400x300, 300x300 all 80mm Depth;
Colour: Silver/Light grey
- PROPOSED LIMESTONE SETTS
Dims: 100x100x80mm (depth);
Colour: Kilkenny Blue Limestone /Dark Grey
- PROPOSED RESIN BOUND GRAVEL
(Buff Colour) SuDS compliant
(with Pin Kerb/Concrete Edge - 50mm width; flush with adjoining ground)
- PROPOSED SAFETY SURFACE
Wetpour rubber - permeable - buff colour
- PROPOSED PERMEABLE PAVING to New Car Park
(to Engineer's Specification)
- PROPOSED PATHWAY - Concrete (to Engineer's Specification)
- PROPOSED TERRACING WITH TIMBER SEATING
(to match with existing terracing)
- PROPOSED SEATING
- PROPOSED LIMESTONE CLAD WALL
- PROPOSED CONCRETE PLANTER
- PROPOSED PEDESTRIAN SURFACE MARKINGS
Buff colour, bitumen surface with thermo plastic markings to delineate pedestrian route
- PROPOSED GUARDRAIL
Height: 1.1m
Color: Black
- PROPOSED HANDRAIL
Height: 1.1m
Color: Black
- EXISTING RAILING TO BE PAINTED
Color: Black
- PROPOSED GUARDRAIL ON RIVER EDGE
Height: 1.1m
Color: Black
- SEDUM ROOF
- PROPOSED SUDS CONSTRUCTED TREE PITS
- PROPOSED CONTOUR LINE

General Notes:

- Refer to Architects drawings for location and dimensions of buildings, details of bin area.
- Refer to Engineer's drawings for details of proposed bridge, main public pedestrian pathways, structural details of retaining wall

4.1.2 Detail Area 1 & Sections

Detail Area 1



Section B - B

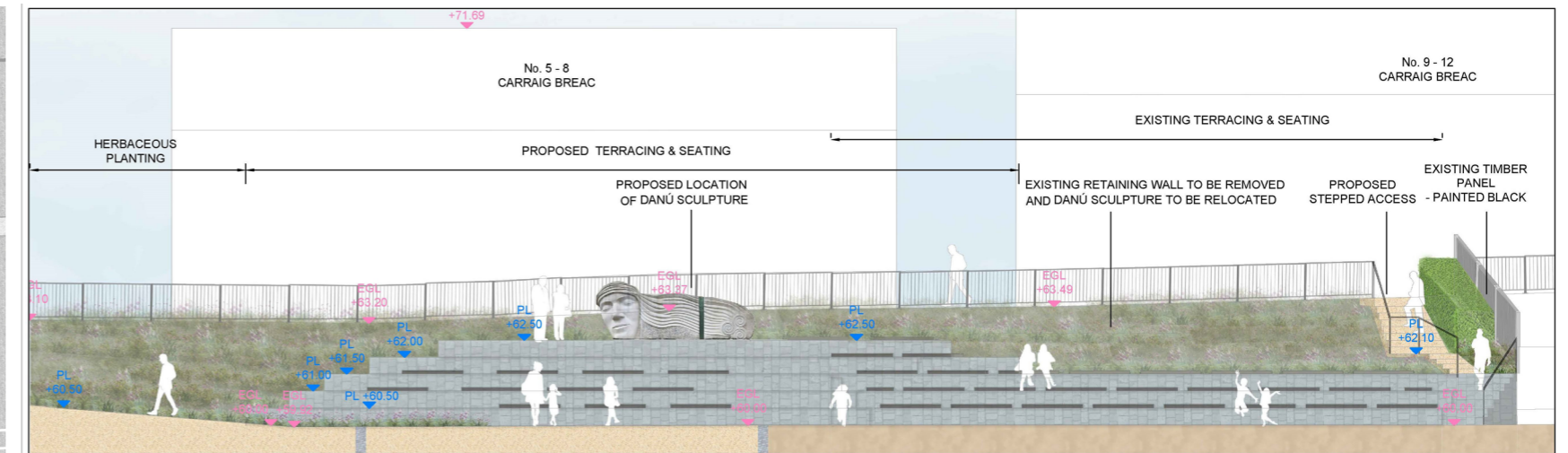

Section A - A

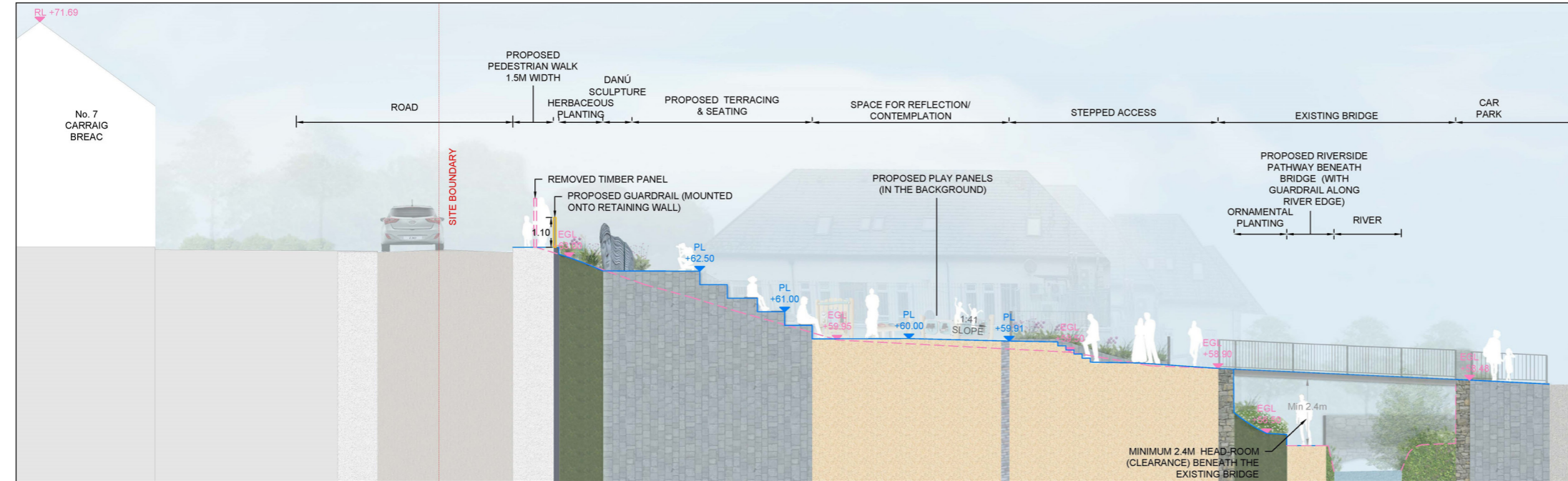

4.1.3 Detail Area 2 & 3

Detail Area 2



Detail Area 3

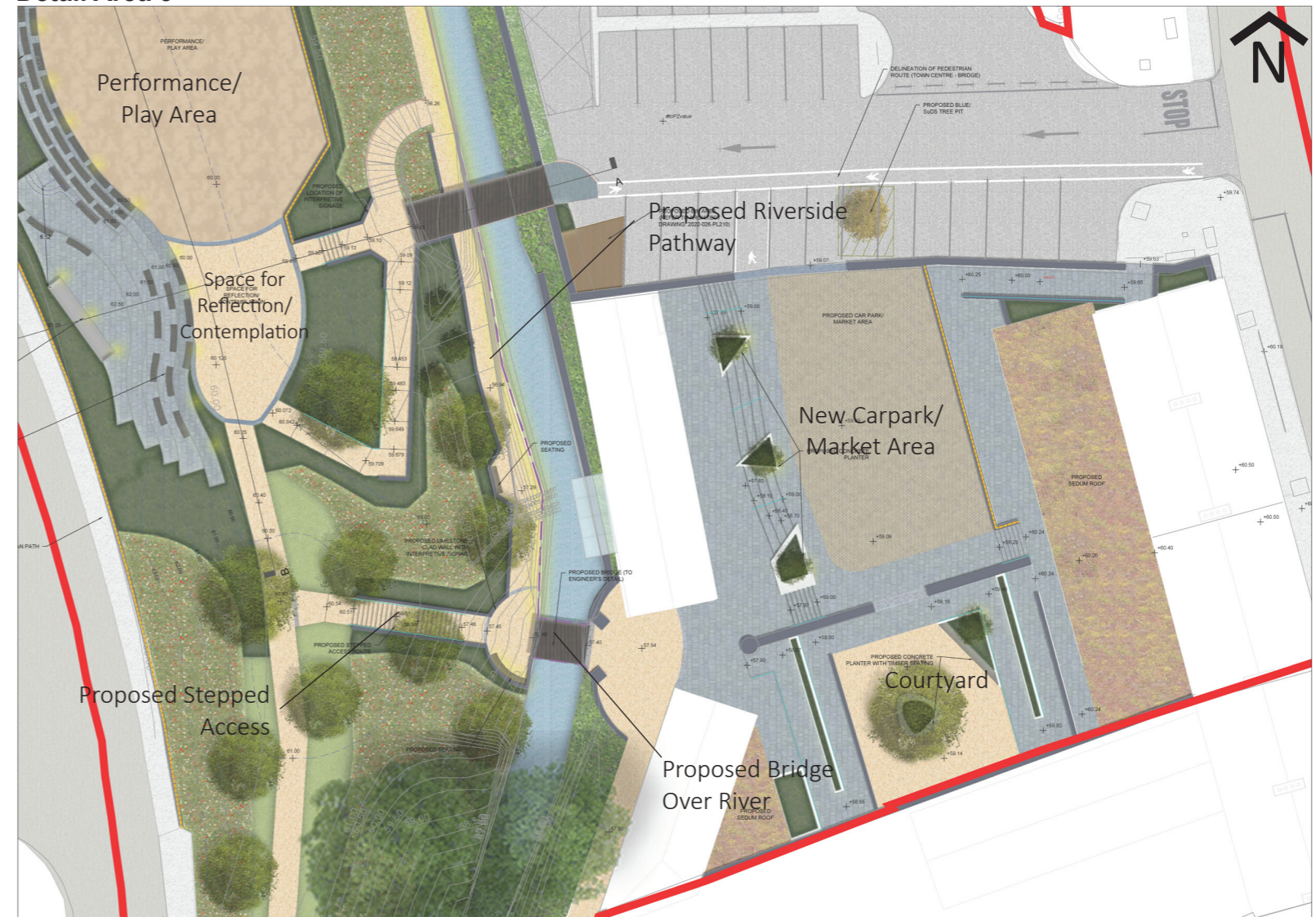

4.1.4 Play Area: Retaining original performance space

- Retaining original performance area/ event space, with the addition of play surface markings & play panels to the boundary with the crèche (northern boundary)
- Minimum visual impact, providing play and learning experience,
- Play panels to the base of the crèche boundary wall - Age range: 1+ years old, allows for 23 users

Notes: Play & Exercise Equipment

Safety Surface: Wet-pour rubber, permeable surface - buff colour

Play & Recreation Standards: All equipment and safety surfacing will conform with European Standards EN 1176-1-11 and EN1177 and will be RoSPA certified.

Play Panel Elements



Play & Learn Blackboard
Kompan (NRO610)
2+ Years, 6 users

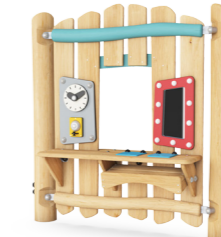

Dress-Up Wall with Mirror
Kompan (NRO603)
1+ Years, 6 users



Percussion Music Panel
Kompan (NRO602)
1+ Years, 3 users



Play Panel - Emotion
Kompan (NRO614)
1+ Years, 8 users



Play Surface Markings



Chessboard



Compass



Hopscotch



Solar system



Snack alphabet

4.1.5 Hardworks Details

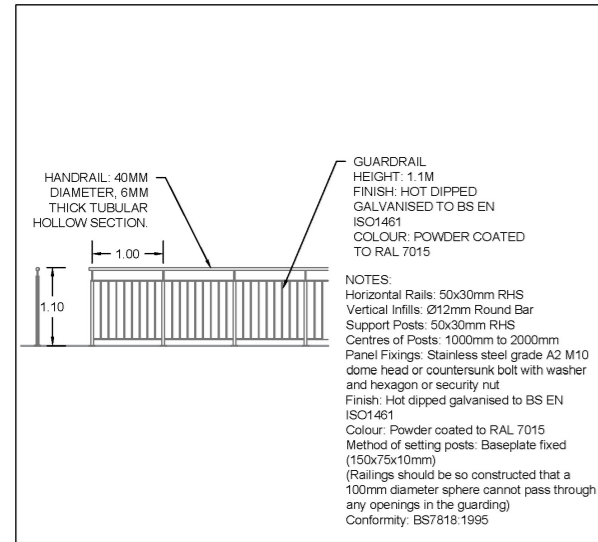

DETAIL 1: GUARDRAIL WITH TOP MOUNTED HANDRAIL TO RIVERSIDE PATHWAY (MATCH WITH EXISTING STYLE OF RAILING) SCALE:1:50

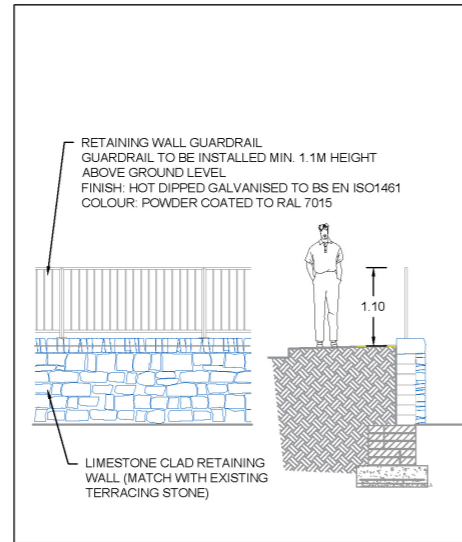

DETAIL 2: LIMESTONE STONE CLAD RETAINING WALL WITH GUARDRAIL (WHERE LEVEL DIFFERENCE IS 600MM OR GREATER) SCALE: 1:50

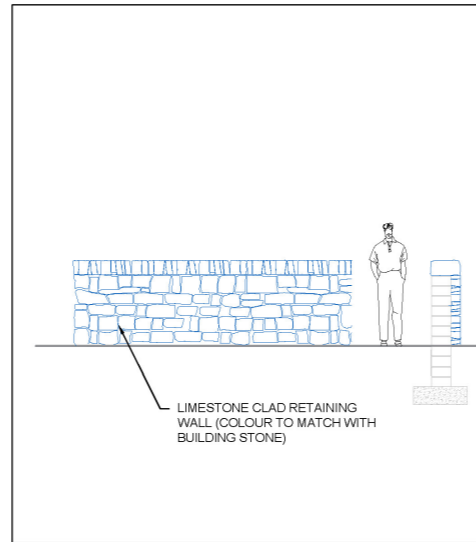

DETAIL 3: LIMESTONE STONE CLAD WALL SCALE: 1:50

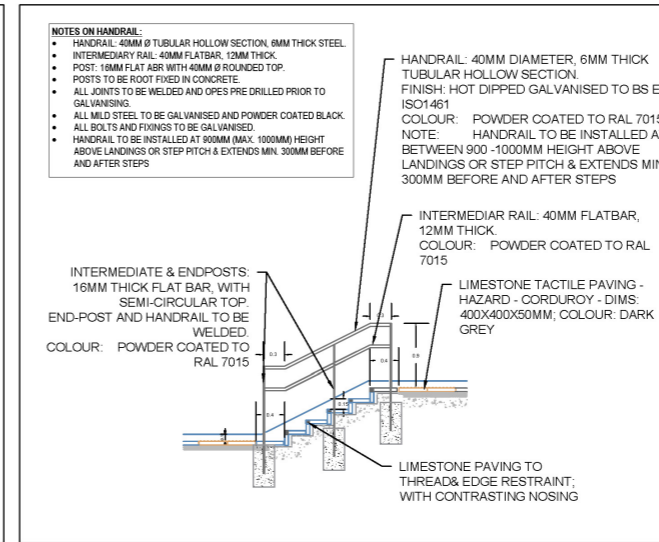

DETAIL 4: HANDRAIL IN THREAD/ PATH TO STEPS / RAMPS (to steps & ramps with level difference of 600mm or less) SCALE:1:50

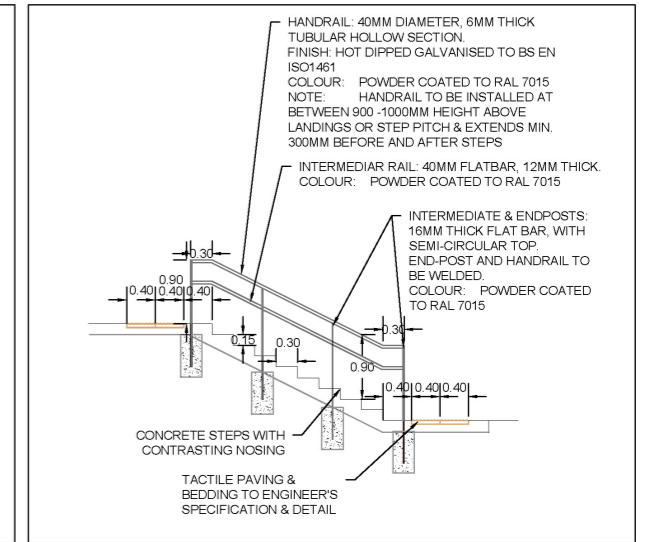

DETAIL 5: HANDRAIL TO STEPS SCALE:1:50

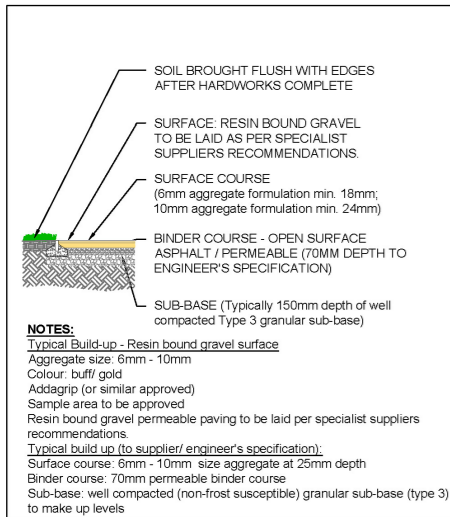

DETAIL 6 : RESIN BOUND GRAVEL (SuDS Compliant) SCALE:1:50

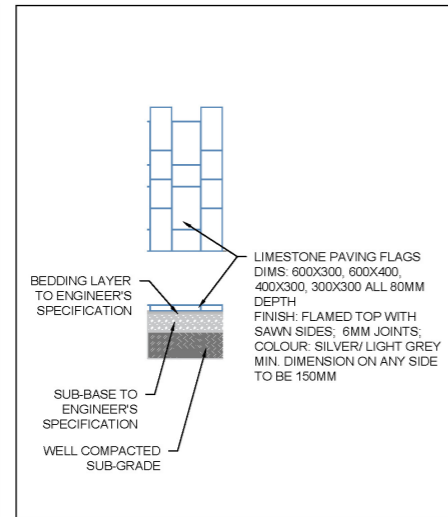

DETAIL 7: LIMESTONE PAVING SCALE:1:50

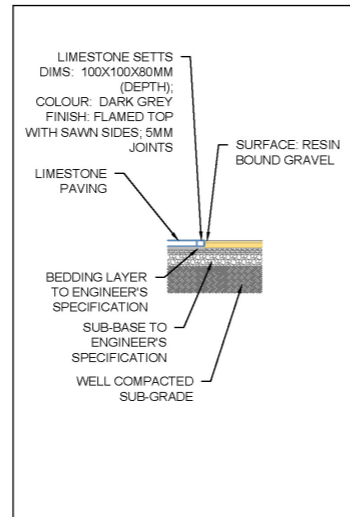

DETAIL 8: LIMESTONE SETTS SCALE:1:50

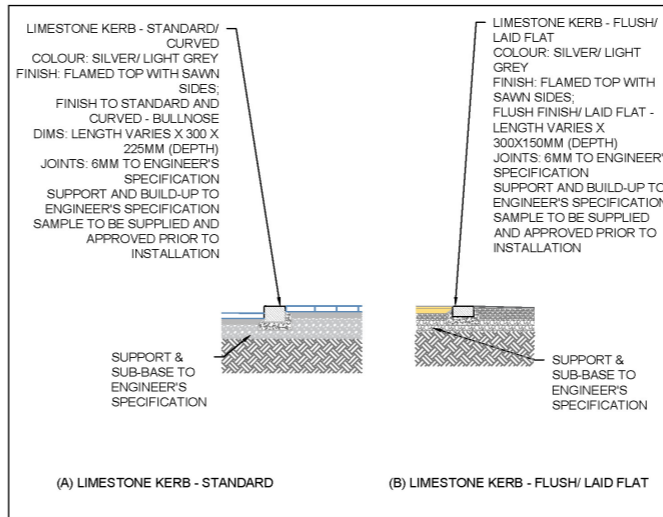

DETAIL 9: LIMESTONE KERB - STANDARD & FLUSH/ LAID FLAT SCALE:1:50

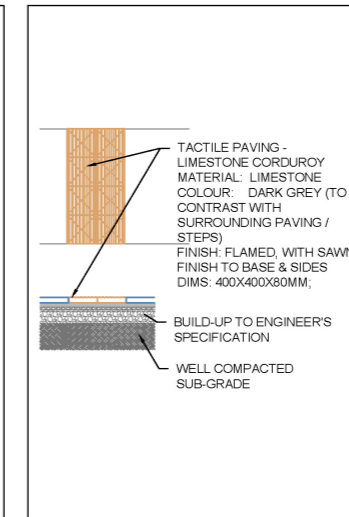

DETAIL 10: LIMESTONE CORDUROY PAVING TO TOP AND BOTTOM OF STEPS SCALE:1:50



Limestone Paving

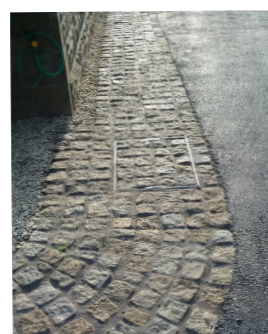

Limestone setts



Permeable resin bound surface
- Path in the park
- Riverside walk



Safety surface
- Play area



Guardrail
- People's park boundary
- Riverside walk



Blue tree pit - water attenuation tree pit
- Car park

4.1.6 Lighting Proposals



Guardrail with lighting
- Installed under the handrail



Guardrail with lighting
- Installed to recess in handrail



Guardrail with lighting
- Installed on guardrail pillar

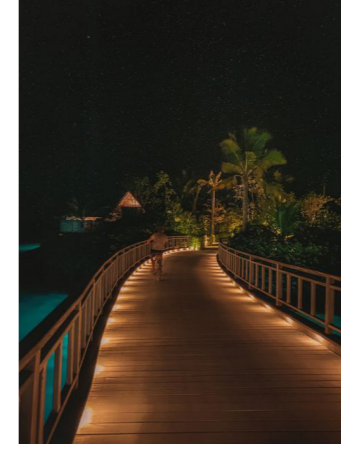

Stepped access with lighting
- Installed to recess in handrail



Stepped access with lighting
- Installed to recess in handrail



Stepped access with lighting
- Installed to recess in handrail

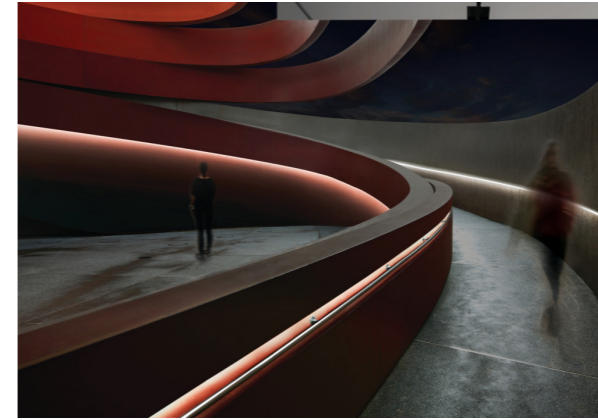

Ramped access with lighting
- Installed to recess in handrail



Ramped access with lighting
- Along the surface edge



Sculpture with lighting
Uplights on the ground

4.1.7 Indicative Planting Schedule

Indicative Planting Schedule		
Proposed Semi-mature Tree Planting - trees to be selected from the following:		
Species Name	Specification	Size (girth/ height)
Aesculus hippocastanum	min.1.8m clear stem, RB	30-35cm; 20-25cm girth
Betula pendula; B. pubescens	min.1.8m clear stem, RB	30-35cm; 20-25cm girth
Prunus avium	min.1.8m clear stem, RB	30-35cm; 20-25cm girth
Q. petraea; Q. robur	min.1.8m clear stem, RB	30-35cm; 20-25cm girth
Sorbus aucuparia	min.1.8m clear stem, RB	30-35cm; 20-25cm girth
Proposed Street Tree Planting (to car park)		
Acer campestre	min.1.8m clear stem, RB	16-18cm girth
Proposed Multi-stem Tree Planting		
Amelanchier lamarckii	Multi-stemmed; Rootballed	2-2.5m high
Acer griseum	Multi-stemmed; Rootballed	2-2.5m high
Prunus avium	Multi-stemmed; Rootballed	2-2.5m high
Riparian Planting to river bank <i>(to be carried out in accordance with the project ecologist's recommendations & LCC approval)</i>		
Species Name	Specification	Size (girth/ height)
<i>Tree Species</i>		
Betula pendula	1.8m clear stem, RB	16-18cm girth
Betula pubescens	1.8m clear stem, RB	16-18cm girth
Quercus robur	1.8m clear stem, RB	16-18cm girth
<i>Understorey Species</i>		
Filipendula ulmaria (Meadowsweet)	1 lt; CG	
Iris pseudacorus (Yellow flag)	1 lt; CG	
Viburnum opulus	1+2, BR, fthd	120-150cm
Native Hedge Planting (to boundary):		
Corylus avellana	1+2, BR, fthd	120-150cm
Crataegus monogyna	1+2, BR, fthd	120-150cm
Ilex aquifolium	1+2, RB, fthd	120-150cm
Prunus spinosa	1+2, BR, fthd	120-150cm

Planting to Swales		
Achillea millefolium	1 litre	CG
Carex pendula	3 litre	CG
Deschampsia cespitosa	3 litre	CG
Iris pseudacorus (Yellow flag)	1 litre	CG
Luzula nivea; L. sylvatica	3 litre	CG
Molinia caerulea	3 litre	CG
Ornamental Planting		
Anemone 'Honorine Jobert'	3 litre	CG
Asplenium scol. 'Angustifolia'	3 litre	CG
Buxus sempervirens	3 litre	CG
Calamagrostis 'Karl Foerster'	3 litre	CG
Deschampsia cespitosa 'Goldtau'	3 litre	CG
Echinacea purpurea 'White Swan'	3 litre	CG
Libertia grandiflora	3 litre	CG
Luzula nivea	3 litre	CG
Pennisetum alopecuroides 'Hameln'	3 litre	CG
Perovskia atriplicifolia 'Blue Spire'	3 litre	CG
Rosa 'Flower Carpet' (white)	3 litre	CG
Salvia nem. 'Caradonna'	3 litre	CG
Salvia x sylvestris 'Schneehugel'	3 litre	CG
Stipa tenuissima 'Ponytails'	3 litre	CG
Verbena bonariensis 'Lollipop'	3 litre	CG
Sensory Planting		
Artemesia absinthium	3 litre	CG
Helichrysum-italicum	3 litre	CG
Lavandula angustifolia c.vars	3 litre	CG
Rosmarinus officinalis	3 litre	CG
Salvia argentea	2 litre	CG
Thulbaghia violacea	2 litre	CG

Turfgrass	
10% Agrostis castellana (Highland Browntop Bent)	
10% Agrostis capillaris (Browntop Bent)	
40% Festuca pratensis (Meadow Fescue)	
40% Festuca rubra (Red Fescue)	
Wildflower/ Native Grass Areas	
Planting to wildflower meadow areas –pollinator friendly and locally sourced species seed mix. Species to be selected in accordance with Project Ecologist recommendations.	
Bulb Planting:	
Allium hollandicum c. vars	
Allium 'Purple Sensation'	
Anemone blanda	
Crocus cvs	
Galanthus nivalis	(of Irish provenance only)
Hyacinthoides non-scripta	(of Irish provenance only)
Narcissus c.vars (3 approx.)	
Tulipa 'White Triumphator'	
Abbreviations:	
RB – root-balled	
BR - Bareroot	
CG – container grown	
xtr. – number of transplants in nursery	
cm g. – girth of tree in centimetres measured 1m above ground	
ltr cg. – plants supplied in e.g. 2 litre volume containers	

