

LEGEND

- PROPOSED STORM SEWER
- EXISTING STORM SEWER
- PROPOSED STORM MANHOLE
- PROPOSED ROAD GULLY
- 300mm TWINWALL PERFORATED PIPE
- PROPOSED FOUL SEWER
- EXISTING FOUL MANHOLE
- PROPOSED FOUL MANHOLE
- IRISH WATER INSPECTION CHAMBER
- FINISHED FLOOR LEVELS
- FINISHED ROAD LEVELS
- MACCAFERRI RETAINING WALL
- GABION BASKET RETAINING WALL
- SITE BOUNDARY

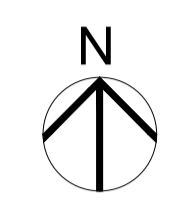

STORM		
MANHOLE REF	COVER LEVEL	INVERT LEVEL
S1	64.850	63.140
S2	62.500	61.614
S3	63.200	61.510
S4	61.700	60.975
S5	59.800	58.300
S6	58.826	58.257
Sout	-	57.925

FOUL		
MANHOLE REF	COVER LEVEL	INVERT LEVEL
F1	64.800	63.450
F2	62.200	60.850
F3	62.100	60.810
F4	62.750	61.248
F5	62.250	60.900
F6	62.100	60.608
Fnew	59.750	56.265

NOTES

WASTE WATER INFRASTRUCTURE

ALL WORKS TO BE CARRIED OUT IN ACCORDANCE WITH IRISH WATER DOCUMENTS IW-CDS-5030-01 (STANDARD DETAILS) & IW-CDS-5030-03 (CODE OF PRACTICE).

INDIVIDUAL WASTEWATER CONNECTION TO EACH DWELLING WILL BE AS PER STANDARD DETAIL DRAWING STD-WW-02.

REFER TO SECTION 3.2 FOR SERVICE CONNECTION GRADIENTS.

THE INSPECTION CHAMBER WILL BE IN COMPLIANCE WITH STD-WW-03 AND STD-WW-13 AND WILL BE LOCATED WITHIN 1M OF EACH SITE BOUNDARY.

PIPE MATERIALS SHALL COMPLY WITH SECTION 3.13 OF THE IRISH WATER CODE OF PRACTICE.

PIPE MATERIALS WILL BE UNPLASTICISED PVC FOR THE MAIN SEWERS AS PER SECTION 3.13.3 OF THE IRISH WATER CODE OF PRACTICE.

COMPLIANCE WITH STANDARD DETAILS DRAWINGS STD-WW-5, STD-WW-6 & STD-WW-6A SHALL BE ADHERED TO REGARDING SEPARATION DISTANCES FROM OTHER SERVICES, BOUNDARY WALLS & TREES.

MANHOLES WILL CONFORM TO STANDARD DETAILS STD-WW-09, STD-WW-10, STD-WW-11 AND/OR STD-WW-12 AS APPROPRIATE.

SEPARATION DISTANCES FROM FOUL SEWERS TO STRUCTURES AND OTHER UTILITIES WILL COMPLY WITH SECTION 3.5 OF THE IRISH WATER CODE OF PRACTICE.

REFER TO STD-W-12A, STD-WW-06, STD-WW-06A & 3.26 OF THE IRISH WATER CODE OF PRACTICE FOR PLANTING RESTRICTIONS OF WATER AND WASTE WATER. ROOT PROTECTION TO BE REROOT 2000 OR SIMILAR.

REFER TO DETAIL STD-W-11 FOR TYPICAL SERVICES LAYOUT DISTANCES & STD-WW-05 FOR WASTEWATER TYPICAL SERVICES LAYOUT AND 3.21 IRISH WATER WASTEWATER CODE OF PRACTICE.

REFER TO SECTION 3.5.16 OF THE WASTE WATER IRISH WATER CODE OF PRACTICE FOR UNAVOIDABLE SERVICES CROSSOVER.

MANHOLE COVERS LOCATED IN GRASS AREAS TO HAVE 200mm ALL ROUND CONCRETE PLINTH AND 100mm DEEP FORMED CONCRETE, 20mm AGGREGATE, BEDDED IN CLAUSE 804 MATERIAL.

REFER TO 3.5.13 OF THE IRISH WATER CODE OF PRACTICE FOR STAGGERED MANHOLE SYSTEMS DETAILS.

EXTERNAL FACE OF PROPOSED MANHOLE CHAMBER TO BE A MINIMUM OF 0.5m FROM KERB LINE AND EXTERNAL FACE OF SEWERS ARE A MINIMUM OF 1M FROM KERB LINE. SEE SECTION 3.5.15 OF IRISH WATER WASTEWATER CODE OF PRACTICE

CONFIRMATION BY A CHARTERED ENGINEER AND TEST RESULT CERTIFICATES INDICATING THAT THE WASTEWATER INFRASTRUCTURE HAS UNDERGONE APPROPRIATE ON-SITE TESTING AND COMMISSIONING. THE APPROPRIATE SITE TESTS FOR WASTEWATER COLLECTION INFRASTRUCTURE WOULD BE AS FOLLOWS:

- AIR TESTS AND WATER TESTS COMPLETION RESULTS FOR SEWERS
- WATER RETAINING TESTS COMPLETION RESULTS FOR MANHOLES AND PUMPING STATION STRUCTURES
- PRESSURE TESTING COMPLETION RESULTS OF RISING MAINS COMPLETE WITH A HARD COPY PRINT OUT FROM THE LOGGER OF THE RELAXATION CURVE AS PROOF OF THE OUTCOME OF THE TEST (IGN 4-01-03 COMPLIANT REPORT)
- A PRINTOUT OF THE JOINT DETAILS, WITH A GPS LOCATION OF EACH JOINT (HOPE WELDING)
- PUMPING STATIONS - TESTING & COMMISSIONING REPORTS

WASTEWATER INFRASTRUCTURE - CCTV & MANHOLE SURVEY REPORTS

REPORTING AND DELIVERING - THE FINAL REPORTS AND DELIVERABLES TO IRISH WATER SHALL INCLUDE THE FOLLOWING ITEMS:

- A - CCTV SURVEY FOOTAGE: FILES IN "XML" FORMAT SUBMITTED TO IRISH IN ACCORDANCE WITH MSC, 5TH ADDITION, COMPATIBLE WITH INFONET.
- B - CCTV REPORTS: REPORTS SUBMITTED IDENTIFYING THAT NO DEFECTS EXIST. REPORTS SUBMITTED IN CD OR DVD FORMAT WITH A HARD COPY OF THE SURVEY REPORT.
- C - MANHOLE SURVEY REPORTS: REPORTS SUBMITTED IDENTIFYING THAT NO DEFECTS EXIST. REPORTS SUBMITTED IN "CSC" FORMAT ON CD OR DVD WITH A HARD COPY OF THE SURVEY REPORTS. MANHOLE REFERENCING SHALL BE CONSISTENT WITH THE AS CONSTRUCTED DRAWINGS - TO IRISH NATIONAL GRID COORDINATES (INGI) TO ±100mm ACCURACY IN THE HORIZONTAL PLANE, WITH DIMENSIONS RELATING TO FIXED ORDNANCE SURVEY CO-ORDINATES.
- D - CERTIFICATION FROM THE CUSTOMERS CONSULTANT ENGINEER: CONFIRMATION THAT A QUALITY CONTROL REGIME HAS BEEN IMPLEMENTED WITH THE RESULT THAT NO DEFECTS EXIST IN EITHER THE SEWERS OR THE MANHOLES.

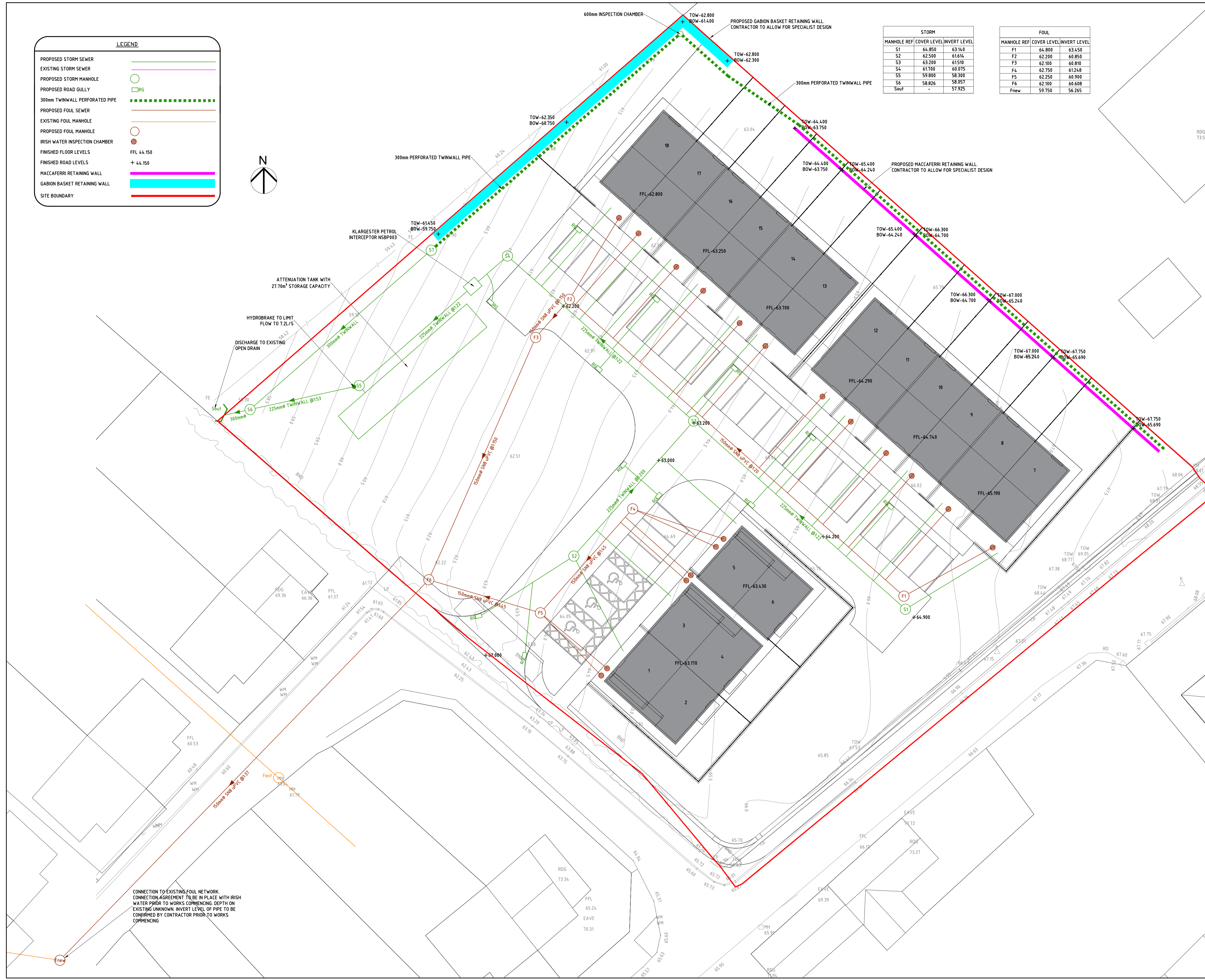

CONNECTION TO EXISTING FOUL NETWORK. CONNECTION AGREEMENT TO BE IN PLACE WITH IRISH WATER PRIOR TO WORKS COMMENCING. DEPTH ON EXISTING UNKNOWN INVERT LEVEL OF PIPE TO BE CONFIRMED BY CONTRACTOR PRIOR TO WORKS COMMENCING.

REV.	DATE	DESCRIPTION	APPROVED

COPYRIGHT RESERVED - THIS DRAWING IS NOT TO BE USED FOR A PURPOSE OTHER THAN THAT FOR WHICH IT HAS BEEN ISSUED BY ALAN TRAYNOR CONSULTING ENGINEERS. NOR IS IT TO BE COPIED OR REPRODUCED IN ANY MANNER WITHOUT WRITTEN CONSENT.

Alan Traynor Consulting Engineers Ltd

Unit 4, Baturst Business Park, Creeny, Baturst, Co. Cavan H14AY94
 TEL: (+353) 49922234
 2nd Floor, 67-70 Meath St, Dublin 8 D08RY93
 TEL: (+353) 19497881
 Email: info@alantaynor.com Website: www.alantaynor.com

ISO 9001 CERTIFICATION EUROPE

Comhairle Chontae Leitrim Leitrim County Council

PROJECT TITLE
CONSTRUCT A HOUSING DEVELOPMENT CONTAINING 18 No. FULLY SERVICED RESIDENTIAL UNITS AT KILBODERRY, CARRICK ON SHANNON, CO. LEITRIM

DRAWING TITLE
SITE SERVICES LAYOUT FOUL AND STORM SEWER

SCALE	DRAWN	CHECKED	APPROVED
1:200	MARC MCBRIDE	LIAM MCELGUNN	ALAN TRAYNOR
	DATE	DATE	DATE
	OCT 2022	OCT 2022	OCT 2022

DRAWING No. **22-074-100**